

**SAMSUNG ELECTRONICS CANADA, INC.**

**HEADQUARTERS**

7037 Financial Drive, Mississauga, Ontario, Canada L5N 6R3

TEL: 1-905-542-3535

[www.samsungcanada.com](http://www.samsungcanada.com)

**SERVICE DIVISION**

7037 Financial Drive, Mississauga, Ontario, Canada L5N 6R3

1-800-SAMSUNG (1-800-726-7864)



# Portable MP3-CD Player

## MCD-MP65

### MP3-CD/CD-R/RW Playback

## Instruction Manual



# Main Features

## MP3-CD, CD-R/RW Playback

You can playback MP3-CDs and audio CDs on the CD-R or CD-RW drive.

## +10 Key

One MP3-CD can contain over 100 MP3 music files. This key is used to skip through tracks in multiples of 10, in order to find the track you want more quickly.

### What is MP3?

MP3 means MPEG1 Layer 3, the global standard for audio signal compression technology. It uses digital compression technology to compress original sound data by up to 12 times without sound quality degradation.

### File Compatibility

- The unit will playback files created in MP3 format (Mpeg1.Layer 3) with \*.mp3 as their extension.
- Files created in MP2 format (Mpeg1.Layer2) with \*.mp2 as their extension can also be played back.

### How many MP3 files can a CD-R or CD-RW disc record?

- The maximum capacity of one CD-R or CD-RW disc is 680MB. Normally, one MP3 file has a capacity of 4MB, therefore approximately 170 files can be recorded on a single disc.

# Contents



Safety Warnings	3
Buttons and Controls	5
Preparation before using your unit	9
How to Connect	9
Using the rechargeable battery	10
Using a standard battery	11
Using the battery pack	12
CD Playback	13
MP3-CD Playback	14
Features	15
• Skip	15
• Search	15
• Repeat Function	16
• Random Function	16
• SBS Function	17
• ESP Function	17
• Last Memory Function	18
• Album Function	19
Maintaining and looking after your unit	21
Troubleshooting Guide	22
Specification	23

# Safety Warning



**Take care not to allow dust or other contaminants to come into contact with your CD player.**

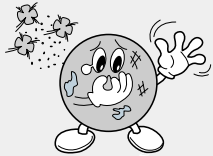

**Do not apply heavy pressure to the main unit or remote control unit.**

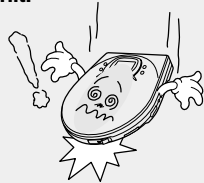

**Do not leave your CD player in direct sunlight or near a heat source.**

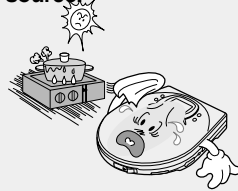

**Do not put anything other than a CD (CD-R or CD-RW) inside your CD player.**

- Such actions will damage your CD player.



**Do not use broken or scratched MP3 CDs.**



**Do not use your CD player on uneven or unstable surfaces.**

- Your CD player may not operate properly in this case.

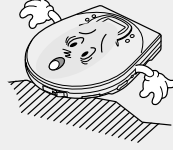

**Do not touch the lens with your finger or scratch it.**

- Your CD player may not operate properly in this case.



**Do not place your CD player in a dusty or humid location.**



**Do not attempt to take apart, repair or modify your CD player.**

- Such actions will damage your CD player.



## Earphones

### Road safety

- Do not use the earphones while riding a bicycle, driving any kind of motor vehicle or motorcycle. This is very dangerous and is illegal in certain regions. It is dangerous to wear earphones at high volume while crossing roads.

### In order to protect your hearing

- Do not wear the earphones with the volume set too high. Doctors state that listening to music at high volume for prolonged periods is harmful to hearing.
- If you experience a ringing in your ears, reduce the volume or stop listening.

**Warning :** Please do not use earphones of other companies besides those of this company.

## Environmental information

- All redundant packing material has been omitted, We have done our utmost to make the packaging easily separable into three materials: cardboard(box), polystyrene foam(buffer) and polyethylene(bags, protective foam sheet).
- Your set consists of materials which can be recycled if disassembled by a specialized company. Please observe the local regulations regarding the disposal of packing materials, exhausted batteries and old equipment.

# Buttons and Controls



## Main Unit

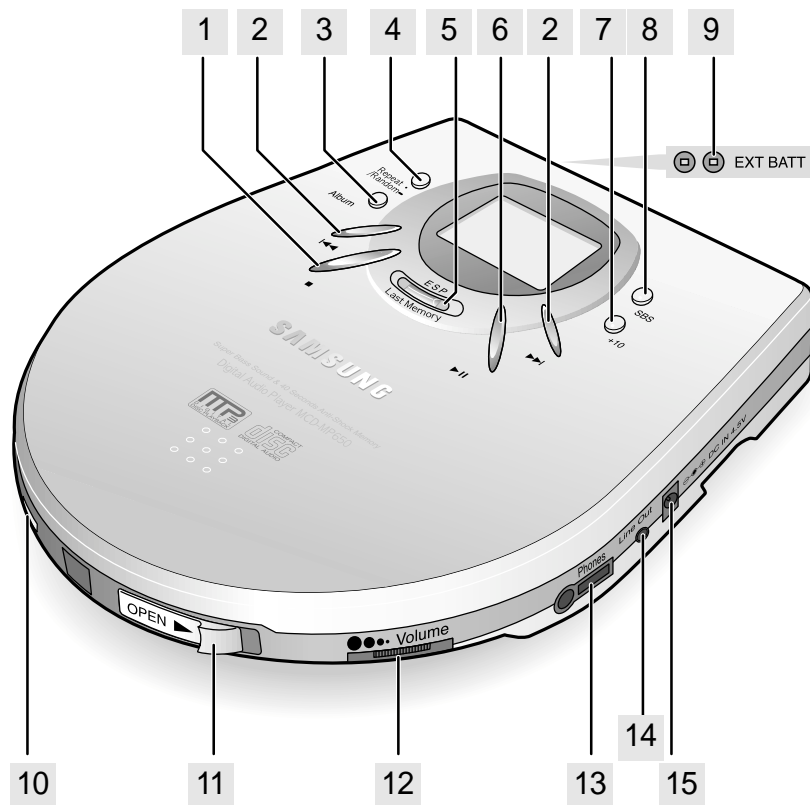

- 1. Stop( ■ ) button**  
At stop mode, press stop again or wait for a while to switch the unit Power "OFF"
- 2. Skip/Search( ◀◀ / ▶▶ ) button**
- 3. Album button(Refer to page 19.)**  
Press this button to select MP3 tracks from an album as a single unit.
- 4. Repeat/Random button(Refer to page 16.)**  
Press and release when you wish to repeat a track. Press button and keep it depressed for a moment if you wish to listen to music in random order.
- 5. Esp/Last Memory button(Refer to pages 17-18.)**  
This button enables you to continue to enjoy normal CD playback even after the machine has been jolted or knocked.
- 6. PLAY/PAUSE( ▶|| ) button**
- 7. + 10 button (Refer to page 15.)**  
This button allows you to skip through 10 tracks at a time.
- 8. SBS button(Refer to page 17.)**  
This button enables you to enjoy realistic and dynamic low pitch sounds.
- 9. Battery Pack Connection Jack (Refer to page 12.)**
- 10. HOLD switch(Refer to page 18.)**  
With the HOLD function selected, you cannot operate any buttons.
- 11. OPEN switch**
- 12. Volume control**
- 13. Earphone Connection Jack (Refer to page 9.)**
- 14. Line Out Connection Jack (Refer to page 9.)**
- 15. Power Input Jack (Refer to page 9.)**  
Connecting the AC adaptor.

# Buttons and Controls



## Display

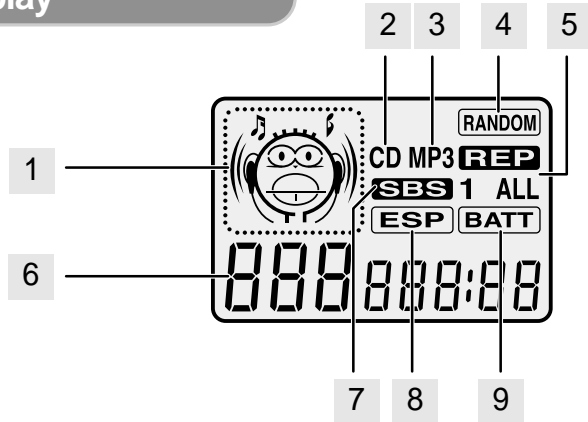

- |  |   |
|--|---|
| <p><b>1. Operation Indicator.</b></p> <p><b>2. Displayed when CD is inserted.</b></p> <p><b>3. Displayed when MP3-CD is inserted.</b></p> <p><b>4. Displayed when songs are selected randomly.</b></p> <p><b>5. Displayed when one or all tracks are repeated.</b></p> <p><b>6. Album number, track number and playing time are displayed.</b></p> | <p><b>7. SBS Indicator.</b></p> <p><b>8. ESP Indicator.</b></p> <p><b>9. Replace Battery Warning Indicator (If battery is fully discharged, the indicator will flash.)</b></p> <p><b>Sorry</b> Displayed when incompatible MP3-CD is inserted.</p> <p><b>Hold</b> Flashes when any control button is pressed while HOLD function is activated.</p> <p><b>LAST</b> When Last Memory is selected, the display shows ON. If the function is cancelled, it shows OFF. (This is displayed only when an MP3-CD is inserted)</p> |
|--|---|

## Accessories

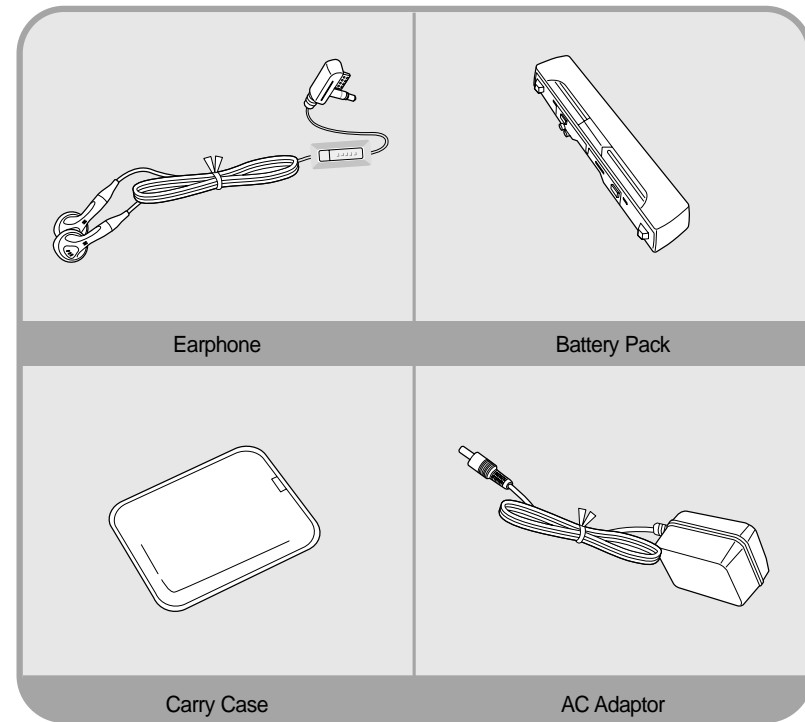

# Preparation before using your unit



## How to Connect

- 1 **Connect the AC adaptor to the power input jack. Then, connect the mains plug of the adaptor to the mains electricity outlet.**
  - Only use the AC adaptor supplied with your product.
  - When you are not using this product, disconnect the AC adaptor from the mains electricity outlet.

- 2 **Connect the earphone jack plug to the main unit.**
  - Reduce the volume on the earphone control while increasing the volume on the main unit volume control.

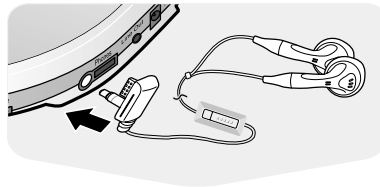

## Using the rechargeable battery (not supplied)

- 1 **Strip the sheath covering the terminals of the rechargeable battery before charging it.**
  - As shown in the illustration, with a knife carefully strip the sheath of the negative (-) terminal by 6 mm.
  - If the sheath is not stripped, charging will not function.

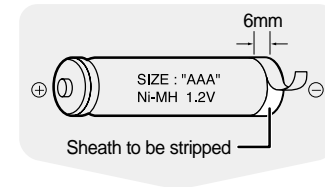

- 2 **Insert the battery into the battery compartment.**
  - Carefully check the correct orientation of the positive and negative terminals of the battery.

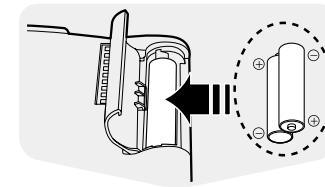

- 3 **Connect the AC adaptor to the mains electricity outlet and power input jack.**
  - Charging of the rechargeable battery will commence.

### Connection to External Device (if necessary)

- \* Your CD Player may be connected to the AUX IN jack of an external device.
1. **Reduce the volume of the external device.**
  2. **Connect the Line Out jack to the Input jack of the device.**
    - Contact your nearest Samsung Service Center for a connection cable.



- **Time taken to fully charge the battery:** 6 hours
- **Battery life of fully charged battery**  
MP3-CD (When ESP is On): 2 hours and 40 minutes  
CD (When ESP is Off): 6 hours



# Preparation before using your unit

## Using a standard battery

**1** Open the cover of the battery compartment.

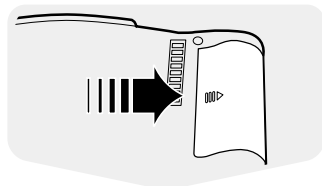

**2** Carefully check the correct orientation of the positive and negative terminals of the battery. Replace the cover.

- Use two AAA type 1.5 V batteries.
- Use two AAA alkaline batteries. Manganese batteries have a shorter battery life.

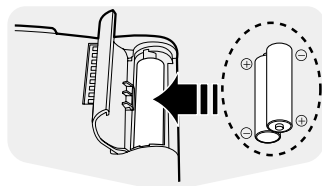

## Battery Life(Using alkaline batteries)

	Main Unit	Main Unit + battery pack ("AAA" type) ("AA" type)
MP3-CD/CD (When ESP is On)	2 hours and 40 minutes	11 hours
CD(When ESP is Off)	6 hours	22 hours



- Do not recharge standard batteries.
- Do not mix the new batteries with the old ones.
- Remove the batteries if they are not in use for a long time.
- Remove the standard batteries when you use an AC adapter.

## Using the battery pack

**1** Open the cover of the battery compartment.

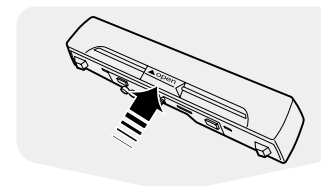

**2** Carefully check the correct orientation of the positive and negative terminals of the battery. Replace the cover.

- Use two AA type 1.5 V batteries.

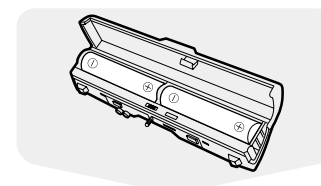

**3** Slide the battery pack into the groove and insert into the battery pack connection port on the rear of the unit.

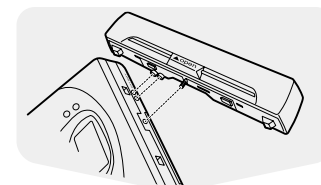

**4** Turn LOCK knob to secure battery pack tightly in position.

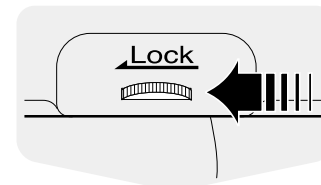

# CD Playback

- 1** Push the OPEN button to open the door. Insert a CD.  
 ● Push the door to close it.

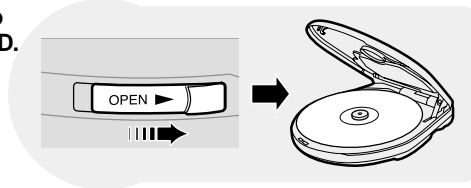

- 2** Press the Play/Pause (▶||) button.  
 ● Once the CD is recognised, playback commences.

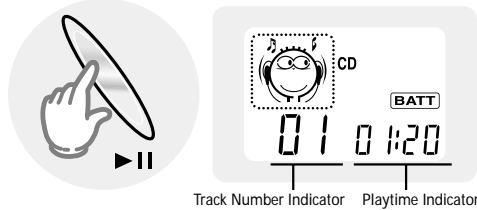

- 3** To stop playback, press the Stop (■) button.

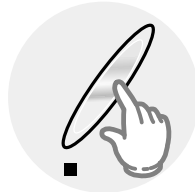

# MP3-CD Playback



This product is an MP3-CD and audio CD player. It cannot record/save mp3 files.

- 1** Push the OPEN button to open the door, and insert an MP3-CD.  
 ● Push the door to close it.

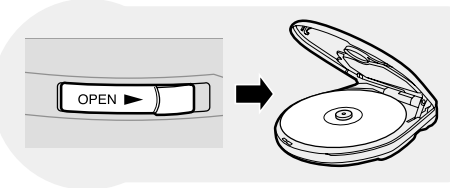

- 2** Press the Play/Pause (▶||) button.  
 ● The inserted MP3-CD will be scanned for about 30–90 seconds. Playback will then commence.  
 ➤ Your CD Player will take a few moments to scan through all the tracks recorded on a particular MP3-CD.

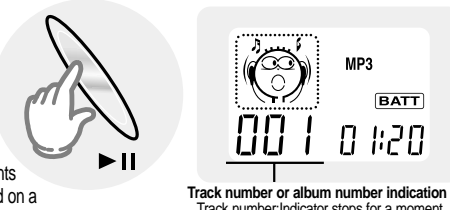

- 3** To stop playback, press the Stop (■) button.

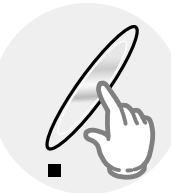

## To temporarily pause playback for a moment

Press the Play/Pause (▶||) button.

- Playback will be temporarily suspended.
- Press the Play/Pause (▶||) button again to resume playback.



- For CD-RW discs, the data written in high speed may not be read properly or the data may not be read properly in accordance with the writing format. In such instances, please try to write the data again.



- When the OPEN switch is slid to open the door, playback of the CD will stop.



# Features



## Skip

Press and release the **◀◀** or **▶▶** button during playback of a CD.

- Press the **▶▶** button to play the next track. Press the **◀◀** button to go back the current track of the beginning. (Briefly press the **◀◀** button twice to repeat the previous track.)
- Press the **▶▶** button while the unit is in "stop" (no playback) mode. Track 2 will be played back. Press the **◀◀** button to play back the previous song.

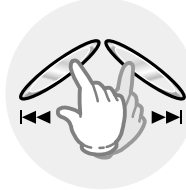

## Search

Press the **◀◀** or **▶▶** button and keep depressed during playback of a CD.

- Press (and keep depressed) the **◀◀** or **▶▶** button. The CD will playback in fast forward or fast reverse mode.
- Release the button to return to normal playback mode.

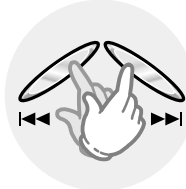

## Repeat Function

Press the Repeat/Random button.

- Each time the button is pressed, REP1 and REP ALL are selected alternately.
- If you want to playback the current track again, select REP1. If you want to repeat playback of all songs, select REP ALL.

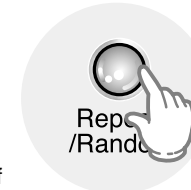

## Random Function

Press the Repeat/Random button and keep depressed.

- All tracks will be played back in random order.
- To cancel this function, press the STOP (■) button.

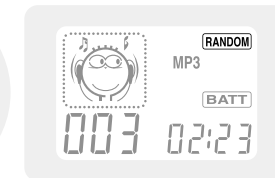
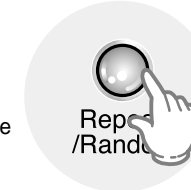

## To skip through 10 tracks at a time

Press the **+10** button briefly while playing back a CD. The track 10 tracks after the current one will then be played back.

example) If you want to select track 43 during playback of track 15, press the **+10** button three times, and then press the **▶▶** button three times.

- Normally use the **+10** button to select move the 10 tracks when MP3-CD is at "Album OFF" Mode.

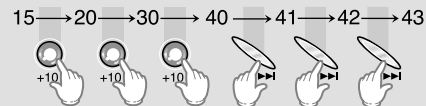

# Features



## SBS Function

### Press the SBS button.

- The SBS function will enable you to maximise your listening enjoyment with dynamic reproduction of low-pitched sounds such as beating drums or galloping horses.
- Each time the SBS button is pressed, SBS will be turned on and off alternately.

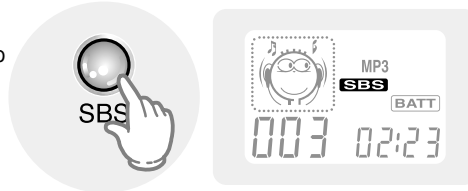

## ESP Function

### Press the ESP button.

- CD Playback: Press the ESP button to turn this function on and off. (During playback of an MP3-CD, ESP will always be active whether or not the ESP button is pressed.)
- CD playback will operate normally even during vibrations or shocks.
- Playbacks may be processed by ESP function with the battery and this function is automatically released when the voltage drops (below 1.7V)



## Last Memory Function

\* This function is only available during playback of a MP3-CD

When MP3-CD playback is selected again after your CD player has been stopped or turned off, this function allows playback from the start of the track that you last listened to.

- To cancel this function, press the button.

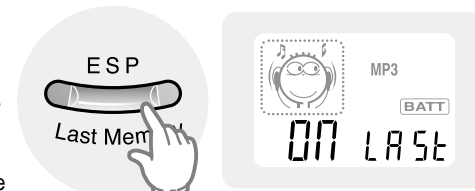

## When the HOLD switch is selected

- Any other button pressed while during CD playback will not function. (on the display, the "HOLD" indicator will flash.)
- Use the HOLD function when carrying your CD Player around with you, in your bag. Use of this function will allow you to conserve battery life as it prevents the CD Player from being turned on unintentionally if a button is pressed inadvertently.

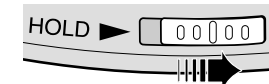

Remote control	remote control unlock key		remote control lock key	
	main set key	remote control key	remote control key	remote control key
Main Set	working	working	working	no working
Main set Lock set	no working	no working	no working	working

# Features



## Album Function

Main Unit

Press the Album button for a short time.

- It moves to the next album.
- example) By pressing the Album button for a short time during Kevin02.mp3 being played, playback of Summer05.mp3 that is the 1st track of the 2nd album will begin.

Songs stored in the ALBUM	Main Unit Display		
	When it is 'ALBUM ON'		When it is 'OFF'
	Track Num.	Album Num.	Track Number Effect display
1. Kevin01.mp3	001	-001-	001
Kevin02.mp3	002	-001-	002
Kevin03.mp3	003	-001-	003
Kevin04.mp3	004	-001-	004
2. Summer05.mp3	001	-002-	005
Summer06.mp3	002	-002-	006
3. Michael07.mp3	001	-003-	007
Michael08.mp3	002	-003-	008

002 00:00 001  
Track Number/Album Number Indication

Press the Album button for a while.

- ON, OFF can be selected.



- This function does not apply to the MP3-CDs that had not been created as album.

- This function is only available during playback of an MP3-CD  
Selection and playback of MP3-CD tracks is fast by the unit of album(directory).

## Playback sequence of albums and tracks

- In case of Window Explorer display.
- The arrows indicates playback sequence of albums and tracks.
- Albums with .jpg, .wav or .doc only are not audio files and therefore will be skipped.

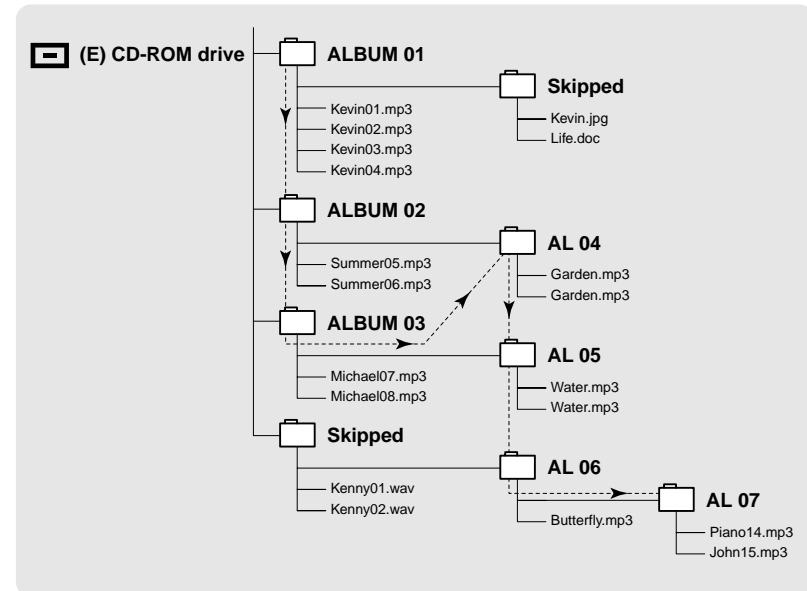

# Maintaining and looking after your unit

## Looking after your CDs

Wash the disc with a neutral detergent diluted in water, and then wipe gently with a soft dry cloth from the center of the disc to the outside.

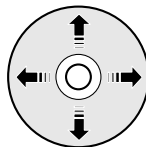

## Handling your CDs

Carefully pick up the disc by its edge without touching the disc's surface.

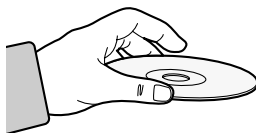

## Deformed discs

Place a heavy book (4~5Kg) on the disc for at least one day.

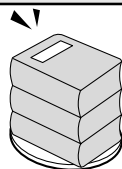

**Note** Do not touch the lens with your finger or scratch it.

- Playback may not function correctly in this case.

# Troubleshooting Guide

## Problem

## Check

Unit has no power.	<ul style="list-style-type: none"> <li>• Did you insert the battery with the correct polarity?</li> <li>• Is the battery exhausted?</li> <li>• Is the AC adaptor connected correctly?</li> <li>• Is the door open?</li> </ul>
Playback does not function.	<ul style="list-style-type: none"> <li>• Is the disc inserted correctly?</li> <li>• Is the disc damaged or deformed?</li> <li>• Has the unit been locked with the HOLD switch?</li> <li>• Has the unit been moved from a cold place to a hot place? Abrupt change of temperature may cause condensation to form on the lens. Keep your CD Player in a warm place until the condensation on the lens has disappeared.</li> </ul>
Earphones don't work.	<ul style="list-style-type: none"> <li>• Is the volume control on the main unit or on the earphones at the minimum setting?</li> <li>• Are the earphones and the main unit connected correctly?</li> </ul>
A sound or track is skipped.	<ul style="list-style-type: none"> <li>• Was the unit jolted or knocked?</li> <li>• Are there dust, fingerprints or scratches on the disc?</li> </ul>
Some of the MP3 files on a CD are not recognised.	<ul style="list-style-type: none"> <li>• Check if the unreadable files have .mp3 as their extension on your PC.</li> </ul>



