

DIGITAL VIDEO CAMCORDER

Instruction Manual

CAMESCOPE ET LECTEUR VIDEO NUMERIQUES

Mode d'emploi

VIDEOCAMARA Y GRABADORA DIGITAL

Manual de Instrucciones

ENGLISH

E

FRANÇAIS

F

ESPAÑOL

Es

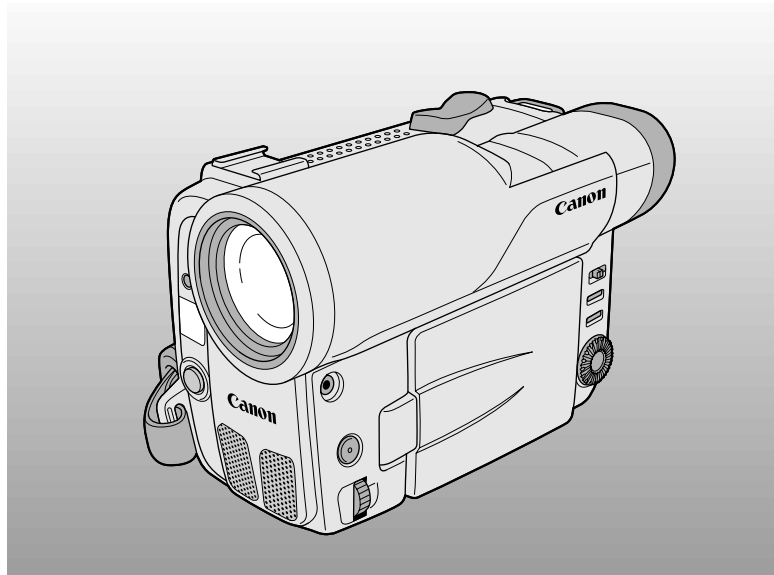

Canon
Ultura

NTSC

Mini **DV** Digital
Video
Cassette

Important Usage Instructions

E

WARNING:



TO REDUCE THE RISK OF FIRE OR ELECTRIC SHOCK, DO NOT EXPOSE THIS PRODUCT TO RAIN OR MOISTURE.

WARNING:



TO REDUCE THE RISK OF ELECTRIC SHOCK AND TO REDUCE ANNOYING INTERFERENCE, USE THE RECOMMENDED ACCESSORIES ONLY.

COPYRIGHT WARNING:

Unauthorized recording of copyrighted materials may infringe on the rights of copyright owners and be contrary to copyright laws.

Digital Video Camcorder, ULTURA and Compact Power Adapter, CA-500A

This device complies with Part 15 of the FCC Rules. Operation is subject to the following two conditions: (1) This device may not cause harmful interference, and (2) this device must accept any interference received, including interference that may cause undesired operation.

Note: This equipment has been tested and found to comply with the limits for class B digital device, pursuant to Part 15 of the FCC Rules. These limits are designed to provide reasonable protection against harmful interference in a residential installation. This equipment generates, uses and can radiate radio frequency energy and, if not installed and use in accordance with the instructions, may cause harmful interference to radio communications. However, there is no guarantee that interference will not occur in a particular installation. If this equipment does cause harmful interference to radio or television reception, which can be determined by turning the equipment off and on, the user is encouraged to try to correct the interference by one or more of the following measures:

- Reorient or relocate the receiving antenna.
- Increase the separation between the equipment and receiver.
- Connect the equipment into an outlet on a circuit different from that to which the receiver is connected.
- Consult the dealer or an experienced radio/TV technician for help.

Use of shielded cable is required to comply with class B limits in Subpart B of Part 15 of FCC Rules. Do not make any changes or modifications to the equipment unless otherwise specified in the manual. If such changes or modifications should be made, you could be required to stop operation of the equipment.

Canon U.S.A. Inc.

One Canon Plaza, Lake Success, NY 11042, U.S.A.

Tel No. (516)328-5600

CAUTION:

TO PREVENT ELECTRIC SHOCK, MATCH WIDE BLADE OF PLUG TO WIDE SLOT, FULLY INSERT.

Important Warning



The lightning flash with arrowhead symbol, within an equilateral triangle, is intended to alert the user to the presence of uninsulated "dangerous voltage" within the product's enclosure, that may be of sufficient magnitude to constitute a risk of electric shock to persons.

CAUTION:

TO REDUCE THE RISK OF ELECTRIC SHOCK, DO NOT REMOVE COVER (OR BACK). NO USER SERVICEABLE PARTS INSIDE. REFER SERVICING TO QUALIFIED SERVICE PERSONNEL.



The exclamation point, within an equilateral triangle, is intended to alert the user to the presence of important operating and maintenance (servicing) instructions in the literature accompanying the product.

IMPORTANT SAFETY INSTRUCTIONS

In these safety instructions the word “product” refers to the Canon Digital Video Camcorder ULTURA and all its accessories.

1. Read Instructions — All the safety and operating instructions should be read before the product is operated.
2. Retain Instructions — The safety and operating instructions should be retained for future reference.
3. Heed Warnings — All warnings on the product and in the operating instructions should be adhered to.
4. Follow Instructions — All operating and maintenance instructions should be followed.
5. Cleaning — Unplug this product from the wall outlet before cleaning. Do not use liquid or aerosol cleaners. The product should be cleaned only as recommended in this manual.
6. Accessories — Do not use accessories not recommended in this manual as they may be hazardous.
7. Avoid magnetic or electric fields — Do not use the camera close to TV transmitters, portable communication devices or other sources of electric or magnetic radiation. They may cause picture interference, or permanently damage the camera.
8. Water and Moisture — Hazard of electric shock — Do not use this product near water or in rainy/moist situations.
9. Placing or Moving — Do not place on an unstable cart, stand, tripod, bracket or table. The product may fall, causing serious injury to a child or adult, and serious damage to the product. A product and cart combination should be moved with care. Quick stops, excessive force, and uneven surfaces may cause the product and cart combination to overturn.



10. Power Sources — The CA-500A Compact Power Adapter should be operated only from the type of power source indicated on the marking label. If you are not sure of the type of power supply to your home, consult your product dealer or local power company. Regarding other power sources such as battery power, refer to instructions in this manual.
11. Polarization — The CA-500A Compact Power Adapter is equipped with a polarized 2-prong plug (a plug having one blade wider than the other). The 2-prong polarized plug will fit into the power outlet only one way. This is a safety feature. If you are unable to insert the plug fully into the outlet, try reversing the plug. If the plug still fails to fit, contact your electrician to replace your obsolete outlet. Do not defeat the safety purpose of the polarized plug.
12. Power Cord Protection — Power cords should be routed so that they are not likely to be walked on or pinched by items placed upon or against them. Pay particular attention to plugs and the point from which the cords exit the product.
13. Outdoor Antenna Grounding — If an outside antenna is connected to the product, be sure the antenna is grounded so as to provide some protection against voltage surges and built-up static charges. Section 810 of the National Electrical Code, ANSI / NFPA No. 70—1984, provides information with respect to proper grounding of the mast and supporting structure, grounding of the lead-in wire to an antenna discharge unit, size of grounding conductors, location of antenna discharge unit, connection to grounding electrodes, and requirements for the grounding electrode. See figure 1.

Fig. 1

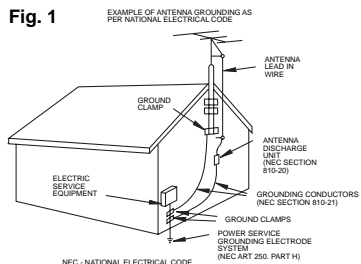

14. **Lightning** — For added protection of this product during a lightning storm, or when it is left unattended and unused for long periods of time, disconnect it from the wall outlet and disconnect the antenna. This will prevent damage to the product due to lightning and power-line surges.
15. **Power Lines** — An outside antenna system should not be located in the vicinity of overhead power lines or other electric light or power circuits, or where it can fall into such power lines or circuits. When installing an outside antenna system, extreme care should be taken to keep from touching such power lines or circuits as contact with them might be fatal.
16. **Overloading** — Do not overload wall outlets and extension cords as this can result in a risk of fire or electric shock.
17. **Objects and Liquid Entry** — Never push objects of any kind into this product through openings as they may touch dangerous voltage points or short out parts that could result in a fire or electric shock. Be careful not to spill liquid of any kind onto the product.
18. **Servicing** — Do not attempt to service this product yourself as opening or removing covers may expose you to dangerous voltage or other hazards. Refer all servicing to qualified service personnel.
19. **Damage Requiring Service** — Disconnect this product from the wall outlet and all power sources including battery, and refer servicing to qualified service personnel under the following conditions:
 - a. When the power-supply cord or plug is damaged.
 - b. If any liquid has been spilled onto, or objects have fallen into, the product.
 - c. If the product has been exposed to rain or water.
 - d. If the product does not operate normally even if you follow the operating instructions. Adjust only those controls that are covered by the operation instructions. Improper adjustment of other controls may result in damage and will often require extensive work by a qualified technician to restore the product to its normal operation.
 - e. If the product has been dropped or the cabinet has been damaged.
 - f. When the product exhibits a distinct change in performance. This indicates a need for service.
20. **Replacement Parts** — When replacement parts are required, be sure the service technician has used replacement parts that are specified by Canon or that have the same characteristics as the original part. Unauthorized substitutions may result in fire, electric shock or other hazards.
21. **Safety Check** — Upon completion of any service or repairs to this product, ask the service technician to perform safety checks to determine that the product is in safe operating order.

"Note to CATV system installer: This reminder is provided to call the CATV system installer's attention to Article 820-40 of the NEC that provides guidelines for proper grounding and, in particular, specifies that the cable ground shall be connected to the grounding system of the building, as close to the point of cable entry as practical".

Contents

Introduction

Important Usage Instructions	2
IMPORTANT SAFETY INSTRUCTIONS	3
Thank you for Choosing a Canon Camcorder	6
Introducing the ULTURA.....	7

Mastering the Basics

Powering Your Camcorder	8
Loading a Cassette	10
Basic Recording	12
Zooming	15
Using the LCD Screen	16
Playing Back a Cassette	19
Connections for Playback on a TV Screen	22
Tips for Making Better Videos	23

Using the Full Range of Features

~ General ... ~

Turning the Optical Image Stabilizer On/Off	25
Selecting from the Menus.....	26
Using the Wireless Controller/Tally Lamp.....	29

~ For Recording ...~

Setting the Date and Time	31
Displaying Data Code	35
Taking Still Pictures (Photo Mode)	37
Searching the Tape (Photo Search/Date Search).....	39
Searching and Reviewing While Recording	40

Using the Various Recording Programs.....	41
Using Digital Effects	45
Audio Recording	48
Setting the Self-Timer	50

~ When Making Manual Adjustments ...~

Adjusting Focus Manually	51
Adjusting Exposure Manually	53
Setting the White Balance	56
Returning to a Pre-Marked Position....	58

Editing

The Auto Editing Function	59
Preparing for Editing	60
Using the Editing Function for the First Time	61
Choosing a Scene	63
Preview and Recording	65
Cut-In and Cut-Out Adjustments	67
Deleting Scenes and Clearing the Program	69
Reordering Scenes	70
Simple Editing to a VCR	71

Additional Information

Preparing the Camera	74
Notes on Using the Batteries	75
Setting the Audio Mix	78
Maintenance	79
Troubleshooting	83
The ULTURA System Diagram	86
Optional Accessories	87
Finding Your Way Around ULTURA..	91
Screen Displays	94
Specifications	98
Index	99

The serial number of this product may be found on the bottom of the camera. No others have the same serial number as yours. You should record the number and other vital information here and retain this book as a permanent record of your purchase to aid identification in case of theft.

Date of Purchase
Dealer Purchased From
Dealer Address
Dealer Phone No.
Model Name ULTURA
Serial No.

Thank you for Choosing a Canon Camcorder

E

First, we'd like to thank you for purchasing this Canon camcorder. Its advanced technology makes it very easy to use — you will soon be making high-quality videos which will give you pleasure for years to come.

To get the most out of your new camcorder, we recommend that you read this manual thoroughly — there are many sophisticated features which will add to your recording enjoyment.

Getting started





To get started we suggest that you master the basic operations of the camcorder first, before moving on to use its full range of features.

For quick reference (in addition to the contents and index) please refer to:

- Finding Your Way Around ULTURA (p. 91)
- Screen Displays (p. 94)
- Troubleshooting — in case you run into any problems (p. 83)

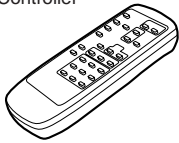
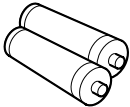
Note that capital letters are used to refer to settings displayed in the menus and buttons labeled on the camcorder itself e.g. Press the EJECT button.

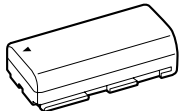
Your camcorder is supplied with the following accessories:

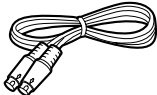
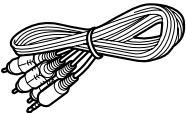
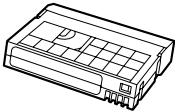
WL-D72 Wireless Controller 	Two AA batteries 
SS-600 Shoulder Strap 	Lens cap and lens cap cord (Attached to camcorder) 
BP-915 Battery Pack 	CA-500 Compact Power Adapter 
Lithium button battery 	S-150 S-video Cable 
STV-250 Stereo Video Cable 	Digital Video Cassette 

Introducing the ULTURA

Digital Video

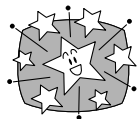

ULTURA is a next generation digital video camcorder that conforms to the new digital video **Mini DV** standard to give you outstanding picture quality.

FlexiZone Control



Easier than manual operation and more flexible than automatic functions, Canon's innovative FlexiZone Control is a unique way to use a video camera.

2.5" LCD Screen

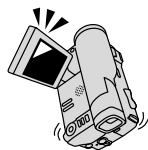

An LCD screen makes it easy for you to shoot colorful, well composed video. It is also great for playback.

Auto editing function

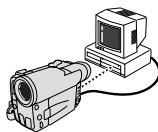

A complete set of editing functions is built-in — turn your recordings into finished productions, with no extra equipment required.

Optical Image Stabilizer



Optical technology stabilizes your recordings even in long telephoto shots.

Digital effects

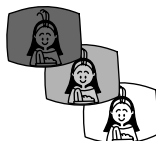

Advanced digital technology allows you to add special effects and varied scene transitions to your recordings.

16× lens and 64×/320× digital zoom



From wide-angle to 16× telephoto — with unparalleled optical quality. The digital zoom magnifies this up to 320× for even more dramatic results.

Internal charging

ULTURA charges a battery pack internally, smoothing the transition between charging and shooting, and allowing for a smaller, lighter AC power adapter.

PCM Digital Sound

DV Terminal (IEEE 1394)

ULTURA is equipped with a DV terminal that conforms to IEEE 1394. By connecting the ULTURA to your computer, you can capture still or motion images on your computer (optional IEEE 1394 computer interface board required).

Photo mode



The ULTURA has the technology to capture crisp, clear, digital still pictures.

Powering Your Camcorder

E

Before operating your camera, you will need to use the power adapter to:

Provide power from an AC outlet

or

Charge a battery pack

Notes:

- The power adapter converts current from a household power socket (100–240 V AC, 50/60 Hz) to the DC current used by your camera.
- If the adapter is used next to a TV, it may cause noise bars to appear on the TV— move the adapter away from the TV or the antenna cable.

Connecting the camera to an AC outlet

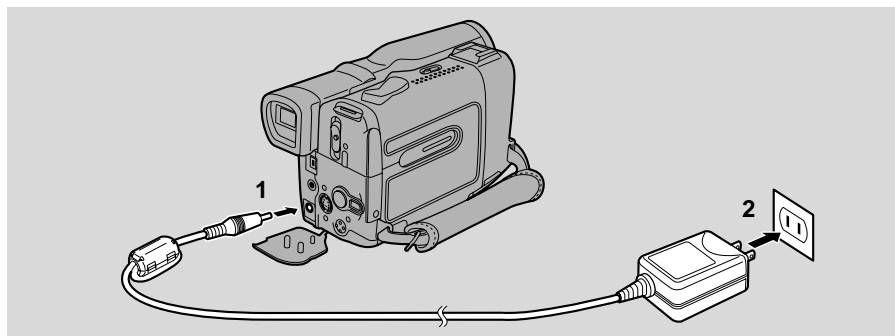

Use the power adapter to provide your camera with instant power from an AC outlet.

- 1. Connect the power adapter to the camera's DC IN terminal.**
- 2. Plug the adapter into an AC outlet.**
- 3. Remove the power adapter after use.**
 - Always turn the camera off before connecting/removing the power source.

CA-500 Compact Power Adapter

Specifications

Power supply	100–240V AC, 50/60Hz
Power consumption	12 W
Rated output	9.5V, 0.8A DC
Operating temperature range	32°–104°F (0°–40°C)
Dimensions	2 1/2 × 1 1/4 × 1 7/8 in (65 × 31 × 49 mm)
Weight	4 1/2 oz (130g)

Weight and dimensions are approximate. Errors and omissions excepted.
Subject to change without notice.

When replacement or repair of any product including power supply is required, please return it to the nearest authorized Canon Service Center and have it repaired or replaced with the same number product or equivalent.

Charging and attaching the battery pack

E

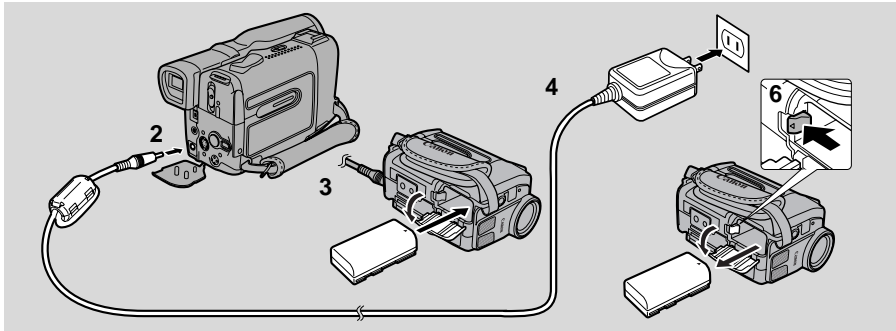

Your battery pack was partially charged before it left the factory. It should have enough power for you to check that your camera is working properly. However, you must charge the battery pack fully if you want it to power the camera for more than a few minutes.

- 1. Set the POWER switch to OFF before you charge the battery pack.**
- 2. Connect the power adapter to the camera.**
- 3. Open the battery cover and insert the battery into the camera.**
 - Insert the battery in the direction of the arrow until it clicks into place, then close the battery cover.
- 4. Plug the adapter into an AC outlet.**
 - The charge indicator flashes red to show that charging is in progress. Single flashes mean that the battery pack is less than 50% charged. Double flashes mean that it is between 50% and 75% charged. Triple flashes mean that it is more than 75% charged. The indicator glows steadily when the battery pack is fully charged.
 - Charging will also take place when the camera is in stop mode during VCR mode, or the power is off in camera mode. This charging will take longer than when the POWER switch is set to OFF.
- 5. When charging is complete, disconnect the power adapter.**
- 6. Remove the battery pack after use.**
 - Place the camera on its side before removing the battery pack, since the battery pack may drop out when you press the battery release button.
 - Press the battery release button to the left.
 - Always turn the camera off before removing the power source.

Note:

- You can find detailed notes for using the batteries in the “Notes on Using the Batteries” on p. 75. These notes include charging and recording times and how to install the backup battery.

Loading a Cassette

E

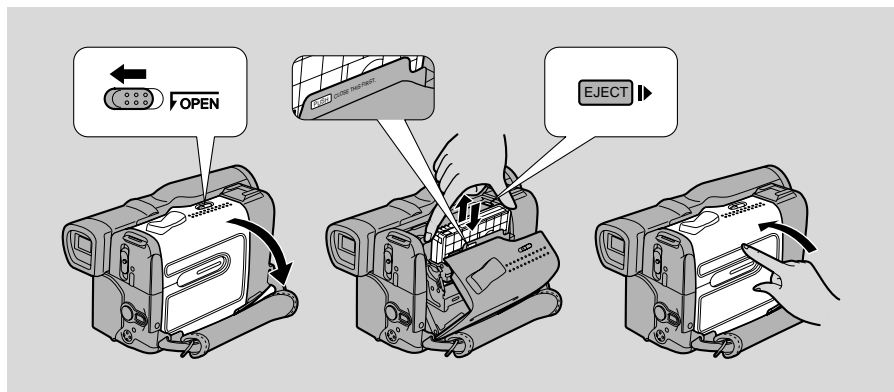

Only use videocassettes marked with the Mini DV logo.*

Loading and unloading

1. Make sure that you have inserted a power source.
2. Slide the **OPEN** button to release the cover (the camera's grip).
 - Pull the cover fully open.
3. Press the **EJECT** ► button and wait for the cassette compartment to open.
4. Load or unload the cassette.
 - Insert the cassette gently with the window facing out.
 - Remove the cassette by pulling it straight out.
5. Press the **PUSH** mark on the compartment until it clicks, and wait for it to close.
6. Click the cover back into place.

* Mini DV is a trade mark

Notes:

- After loading a cassette, use record search (p. 40) to find the point where you want to start recording.
- Do not interfere with the cassette compartment while it is opening or closing automatically, or attempt to close the cover.
- Do not leave the cassette in the camera after use — return it to its case and store it in a cool, clean, dry place.
- The holes in the back of the cassette are used for transferring information — do not cover them.
- When a cassette is not loaded,  flashes in the display.

Protecting tapes from accidental erasure

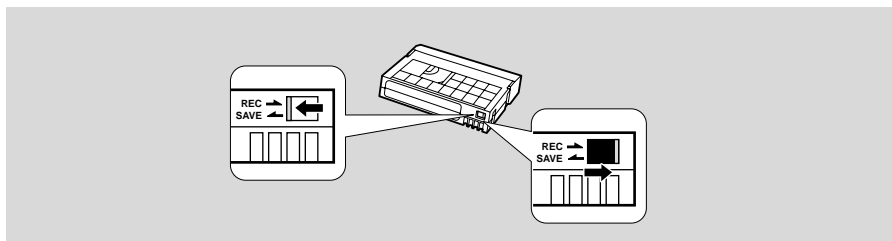

To protect your recording from accidental erasure, slide the tab on the cassette so that it exposes the hole. (This switch position is usually labeled SAVE or ERASE OFF.)

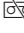
If you load this cassette and put the camera in record pause mode (p. 12), “THE TAPE IS SET FOR ERASURE PREVENTION” is displayed for approx. 4 seconds and then the  mark flashes in the display. The camera also shows the above phrase if you accidentally press the DV REC button with the camera switched to VCR mode.

If you want to record on the cassette again, slide the tab back so the hole is closed.

Handling cassettes

- To protect the tape heads, transfer cassettes directly from the tape case to the camcorder — do not open the tape protect cover or touch the tape itself.
- Do not use cassettes where the tape has been damaged or spliced — they may damage the camcorder.
- Do not insert anything into the small holes on the cassette or cover them with cellophane tape.
- Handle cassettes with care — dropping them or exposing them to external shocks may cause internal damage.
- Store cassettes in the provided case, first rewinding them to the start of the tape, and then storing them upright.
- A cassette with metal plated terminals may become dirty with use, affecting information transfer. Therefore, after using a tape around ten times, be sure to clean the terminals with a cotton swab.

Cassette Memory

You cannot use the cassette memory function with this camcorder.

Basic Recording

E

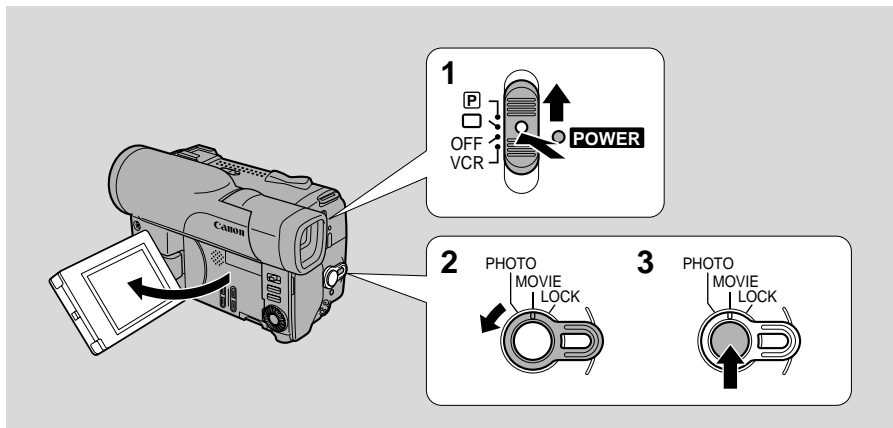

Before you start recording

Have you completed the following steps?

- Attached a power source (p. 8).
- Loaded a cassette (p. 10).
- Removed the lens cap and fastened the grip belt (p. 74).
- Chosen the display: viewfinder or LCD screen (p. 16)
- Adjusted the viewfinder (as applicable, p. 74).

You may also want to install the backup battery (p. 76) in order to set the date and time display (p. 31).

To record

- 1. Press down and slide the POWER switch to .**
 - The camera power indicator lights up red.
 - This selects the camera's Easy Recording program. It allows you to simply point and shoot without making any manual adjustments (see p. 42).
- 2. Turn the standby lever to MOVIE.**
 - PAUSE appears in the display — the camera is now in “record pause mode.”
 - The camera will turn itself off if you leave it in record pause mode for more than about five minutes. To return to record pause mode, turn the standby lever to LOCK and back again, or set the POWER switch to OFF and then back to .
- 3. Press the start/stop button to begin recording.**
 - The tally lamp flashes rapidly and REC appears in the display.
 - It is convenient to use the start/stop button on the front cover when you shoot low angle recordings.

4. Press the start/stop button again to pause recording.

- The camera returns to record pause mode and PAUSE reappears in the display.
- You can stop and restart recording as often as you like by pressing the start/stop button.

5. Turn the standby lever to LOCK.

- As long as the POWER switch is set to or (see p. 12), you can use the standby lever to turn the camera on and off. This makes it easy to save battery power, and prevents accidental operation of the start/stop button. It is also useful when you want the camera to remember your manual settings, such as white balance and shutter speed.

When you have finished recording

- Replace the lens cap.
- Lower the viewfinder.
- Return the LCD screen flush to the camera body.
- Unload the cassette.
- Set the POWER switch to OFF.
- Disconnect the power source.

Notes:

- In addition to (Easy Recording), the camera has seven other recording programs. Slide the POWER switch to the position to give you access to these recording programs (p. 41) and also to the digital effects (p. 45).
- To check that the camera is recording correctly, make a test recording first.
- Before making important recordings, clean the video heads using a Canon DVM-CL Digital Video Head Cleaning Cassette or a commercially available digital video head cleaning cassette.
- To close the LCD panel, rotate it vertically until the screen faces you, then push it in flat against the side of the camera until it clicks securely.
- You cannot monitor the sound from the speaker when recording, you can use headphones instead.
- For tips on how to make better videos, see page 23.
- For extra recording time, set REC MODE in the camera menu to LP.
- The flashing of the tally lamp may be reflected into the lens during close-up recording, or when recording through glass. You may therefore decide to turn it off (p. 30).

Changing the recording mode (SP/LP)

You can record and play back a tape in SP (standard play) and LP (long play) modes. LP extends tape usage by 1.5 times.

To switch to LP mode, select REC MODE from the camera or VCR menu, select LP and then close the menu (for instructions on how to use the menus, refer to page 26).

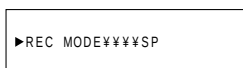

Notes:

- When recording and playing back tapes in LP mode, the nature of the tape and usage conditions may affect recording. Mosaic-like noise may appear in the image and the sound may be distorted during playback of tapes recorded in LP mode. For important recordings, therefore, set the camera to SP mode.
- If you record in both modes on the same tape, the picture may become distorted during playback and the time code may not be written correctly.
- A tape recorded in LP mode on other digital equipment may produce mosaic-like noise and the sound may become distorted when played back on this camcorder, and vice versa.

Zooming

E

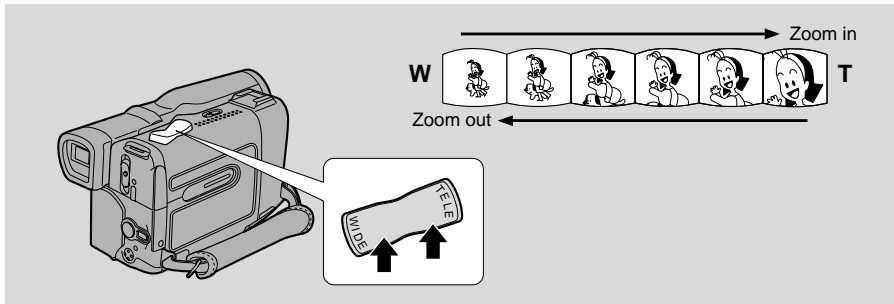

16× optical zoom

The camera's 16× zoom lens allows you to choose the best picture angle for each scene:

- Press the zoom control towards WIDE to zoom out to wide-angle.
- Press it towards TELE to zoom in to telephoto.

You can also control the speed of zooming:

- Press the control slightly to zoom slowly.
- Press it further to zoom more quickly. (The further you press the zoom control, the faster the zoom speed.)

The T and W buttons on the wireless controller adjust the picture angle, but not the zoom speed.

64×/320× digital zoom

Turn the digital zoom on by choosing D. ZOOM from the camera menu, to magnify the camera's zoom range by up to 20×.

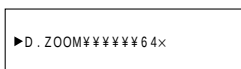

(For an explanation of how to use the camera menu see page 26)

The zoom control continues to work as usual. You can freely zoom in and out between 1× and 64× or 1× and 320× magnification — the camera automatically switches between optical zooming (up to 16×) and digital zooming (16× to 320×).

Notes:

- When you want to get as close as possible to your subject, keep the zoom at the wide-angle position. You can focus on a subject as close as 3/8 in (1 cm).
- Image resolution decreases the further you zoom towards 320× in digital zoom range.
- When the digital zoom is set to 64×, the zoom indicator extends (light blue). When the digital zoom is set to 320× zoom, the zoom indicator extends again (a darker blue).

Using the LCD Screen

E

Switching between displays

When you open the LCD screen, it turns on. When you close it, the viewfinder turns on instead. When the LCD screen is closed with its screen side facing up, the LCD screen remains on.

Changing the angle of the LCD screen

You can choose the angle of the screen that suits you best by opening and rotating the screen, also you can rotate the LCD screen so that faces in the direction of the lens.

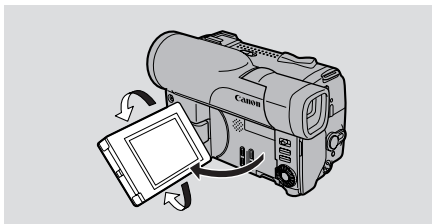

Notes:

- Avoid touching the LCD screen when moving the LCD panel.
- Do not hold the camera by the LCD panel or the viewfinder.
- Make sure you open the LCD panel at 90°, before attempting to rotate it backwards or forwards.
- Always rotate the LCD panel vertically into place, before closing it or pushing it flat against the side of the camera.
- Always fully close the LCD panel until it clicks securely.
- Be careful not to leave the LCD, viewfinder or lens exposed to direct sunlight outdoors or in a window. Doing so could cause damage.
- Bright light falling on the LCD screen may cause glare that makes it difficult for you to view the image. In this case, switch to using the viewfinder.

About the LCD Viewfinder/Screen

The LCD screen built into this camcorder is a high precision product. However, small black dots or bright points of light (red, blue or green) may appear on the LCD screen. This is not a malfunction of the LCD screen and they are not recorded on the tape. (Effective dots: more than 99.99%)

Allowing the subject to monitor recording

When you turn the LCD panel so that it faces the opposite direction (see diagram opposite), you can watch yourself during recording or let your subject monitor recording.

The viewfinder is also activated when the panel is in this position.

- During this “monitor recording”, you can choose the display style, reversed (mirror on) or not (mirror off) from the camera menu.

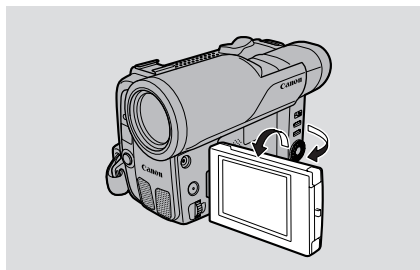

MENU
(see p. 26)

▶MIRROR*YYYYY*ON

(For an explanation of how to use the camera menu see page 26)

If you choose the mirror-on, the recording itself is unaffected.

- During “monitor recording”, the recording time and remaining tape indicators disappear.

Note:

- During “mirror mode recording”, you cannot operate the following functions;
 - Volume control of built-in speaker and headphones
 - LCD screen brightness adjustment
 - Digital effects*
 - Menu*
 - Shutter speed*
 - Program AE*

* Except when the LCD screen is closed with its screen side facing up.

Indications that appear when “mirror” is selected:

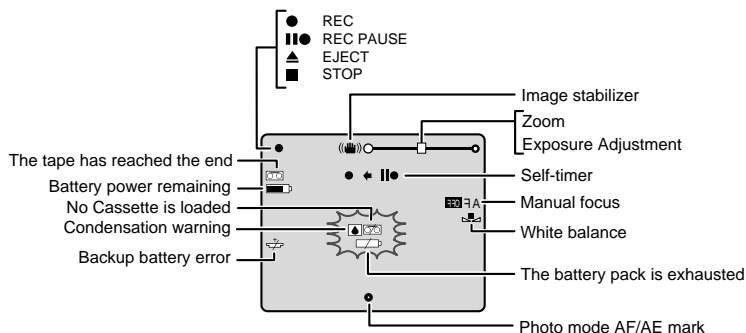

- These indicators appear normally in the viewfinder.

Built-in speaker

The camcorder has a built-in speaker so you can review the sound track alongside the picture during playback.

Adjust the speaker volume by pressing the volume control buttons.

- A VOLUME bar appears in the display to indicate the current volume.
- You can turn off the built-in speaker completely by pressing the ▼ button so that OFF appears.
- You can also adjust the headphones volume separately from the built-in speaker.
- The levels you adjusted for the built-in speaker and headphones are memorized separately. The camera remembers your levels even if you turn the camera off and back on again.

Note:

- The speaker turns off when the camera is set to camera mode or when you use headphones.

Playing Back a Cassette

E

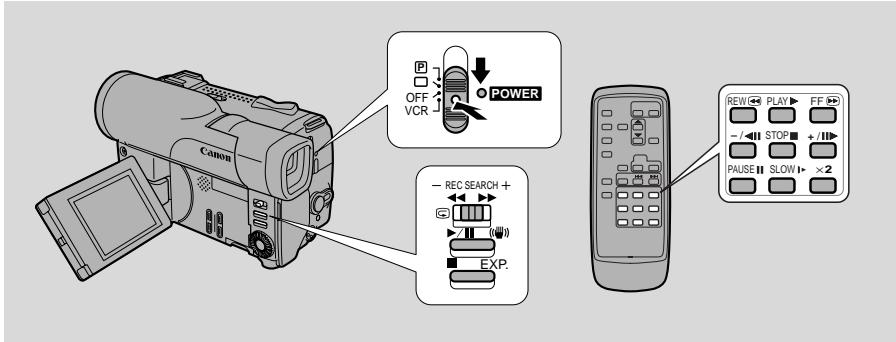

You can use the LCD screen for instant, on-the-spot playback. The camera also plays back the sound track via the built-in speaker (p. 18).

- When you play back a tape, it is convenient to close the LCD screen with its screen side facing up.
- When the LCD screen is closed with its screen side facing inwards, you can monitor the playback using the viewfinder. However, you can only monitor the sound track using headphones.

To play back your recordings on a TV, see p. 22.

To use the wireless controller, see p. 29.

Note:

- To avoid accidental recording, make sure that you slide the tab on the cassette so that it exposes the hole (the switch position is usually labeled SAVE or ERASE OFF).

1. Attach a power source and slide the **POWER** switch to **VCR**.

- The power indicator lights up green.

2. Load the cassette.

3. Press the **PLAY** ► button to start playback.

- To end playback, press the **STOP** ■ button.
- To wind the tape forwards, stop playback and press the **FF** ►► button.
- To wind the tape backwards, stop playback and press the **REW** ◀◀ button.
- If the playback picture is rough (mosaic-like noise), clean the video heads using a Canon DVM-CL Digital Video Head Cleaning Cassette or a commercially available digital video head cleaning cassette.

Other playback modes

Playback pause

Press the PAUSE **||** button. To resume normal playback, press it again, or press the PLAY **▶** button. The camera automatically goes into stop mode after about five minutes' playback pause.

Fast forward playback

To play back the recording at about 9.5 times normal speed, press and hold the FF **▶▶** button during normal playback or press and hold the FF **▶▶** button during normal fast forward.

Rewind playback

For reverse playback at about 9.5 times normal speed, press and hold the REW **◀◀** button during normal playback or press and hold the REW **◀◀** button during normal rewind.

Special playback

All these modes except for Frame Advance and Frame Reverse can only be operated from the wireless controller (p. 29).

Frame Advance

To play back frame by frame, press the +/▶▶▶ button or turn the command dial (on the camera body) clockwise repeatedly during playback pause.

Press and hold +/▶▶▶ to play back frame by frame continuously.

Frame Reverse

To play back in reverse frame by frame, press the -/◀◀◀ button or turn the command dial (on the camera body) counter-clockwise repeatedly during playback pause.

Press and hold -/◀◀◀ to play back frame by frame in reverse continuously.

Slow Forward Playback

To play back at about 1/5 normal speed, press the SLOW ▶▶▶ button during normal playback.

Press the PLAY ▶▶▶ button to return to normal playback.

- The camera automatically returns to playback after about 30 seconds of slow playback.

Slow Reverse Playback

To play back in reverse at about 1/5 normal speed, press the -/◀◀◀ button and then the SLOW ▶▶▶ button during normal playback.

Press PLAY ▶▶▶ to return to normal playback.

- The camera automatically returns to ×1 reverse playback after about 30 seconds of slow playback.

Reverse Playback

To play back in reverse at normal speed, press the -/◀◀◀ button during normal forward playback.

Press the PLAY ▶▶▶ button to return to normal forward playback.

Forward ×2 Playback

Press the ×2 button during normal playback.

Press the PLAY ▶▶▶ button to return to normal playback.

Reverse ×2 Playback

Press the -/◀◀◀ button and then the ×2 button during normal playback.

Press the PLAY ▶▶▶ button to return to normal playback.

Note:

- Mosaic-like noise appears on the screen during some of the VCR modes and the sound track cannot be heard.

Connections for Playback on a TV Screen

E

You can connect the camera to a TV or VCR in order to play back your recordings. You will need to attach a power source to the camera (see p. 8).

See your TV or VCR instruction manual for further details.

If your TV (or VCR) has an S-video input terminal

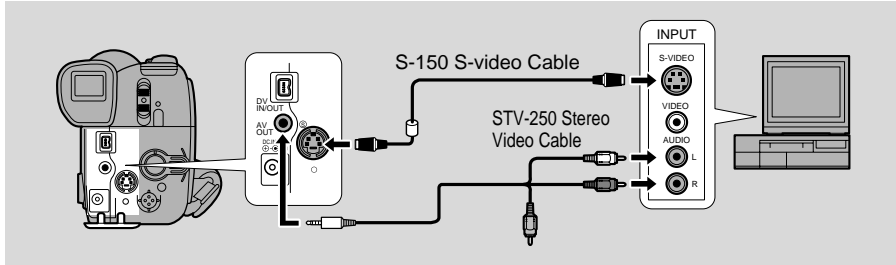

- Use the S-150 S-video Cable to connect the S-video terminal (S). Use the STV-250 Stereo Video Cable, to connect the AUDIO terminals. Connect the white plug to the white AUDIO terminal (L) (left). Connect the red plug to the red AUDIO terminal (R) (right). Do not connect the yellow plug.
- Set the TV/VIDEO selector on the television to VIDEO.
- If you are connecting the camera to a VCR, set the input selector on the VCR to LINE.

If your TV (or VCR) has audio/video input terminals

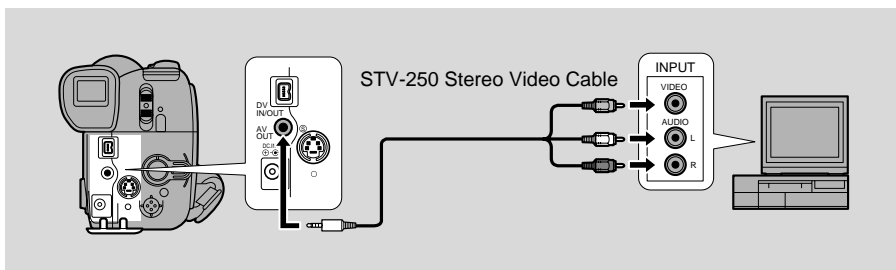

- Connect the camera using the STV-250 Stereo Video Cable. Connect the white plug to the white audio terminal (L) (left). Connect the red plug to the red audio terminal (R) (right). Connect the yellow plug to the yellow video terminal (V).
- Set the TV/VIDEO selector on the television to VIDEO.
- If you are connecting the camera to a VCR, set the input selector on the VCR to LINE.

Note:

- If you are going to use the TV as a monitor while you are shooting, remember to keep the TV volume turned down as long as the camera's audio terminals are connected. If the sound from the TV speakers is picked up by the microphone, an unpleasant high-pitched squeal, called feedback, may be produced.

Tips for Making Better Videos

E

Holding the camera

For maximum stability, grip the camera firmly with your right hand and keep your right elbow pressed against your body. Support the camera under the lens with your left hand. With practice, you will be able to operate the controls by touch, without taking your eye off the action.



Using a tripod

To prevent any unwanted movement, you can mount the camera on a tripod, (or any flat surface at a suitable height.) and operate it with the wireless controller.

- When you are using a tripod, be careful not to leave the viewfinder exposed to bright sunlight or it may melt. (The light is concentrated by the viewfinder lens.)
- Make sure that the fastening screw of the tripod is no longer than 1/4 inch (5.5 mm), or it will damage the camera.



Composition

The most important element in the scene does not have to be in the center. For a more interesting picture, try to position your subject so it is slightly to one side. Leave some space on the side of the frame that the subject is facing or moving towards.



Don't cut off the top of the subject's head, and don't cut people off at the neck, hips or knees (move a little bit above or below).

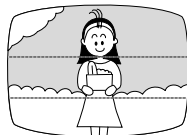

Watch out for distracting objects in the background.



Picture angle

Instead of zooming while recording, try to choose your picture angle before you begin. A good way to tell a story with video is to begin with a long shot that establishes the situation, and then move in with medium shots and close-ups to show the details. Remember to change your viewpoint for each shot.

Remember that any camera movement or change in picture angle should have a definite purpose. Avoid unnecessary or half-hearted movements.



Long shot



Medium shot



Close-up

Camera moves

Use pans to record a landscape or follow a moving subject. Decide the area you want to cover and stand facing the end of your panning angle. Without moving your feet, turn your waist to the starting position. Start recording, and after a few seconds begin to turn slowly from the waist. Hold the final image for a few seconds before you stop recording.

Tilt the camera up to exaggerate the height of the subject. Tilt down from the top of a building, for example, as an introduction to subjects at the bottom.

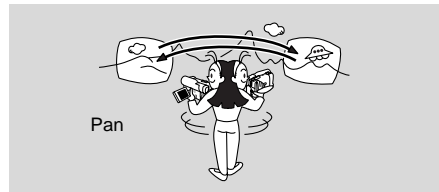

Pan



Tilt

Turning the Optical Image Stabilizer On/Off

E

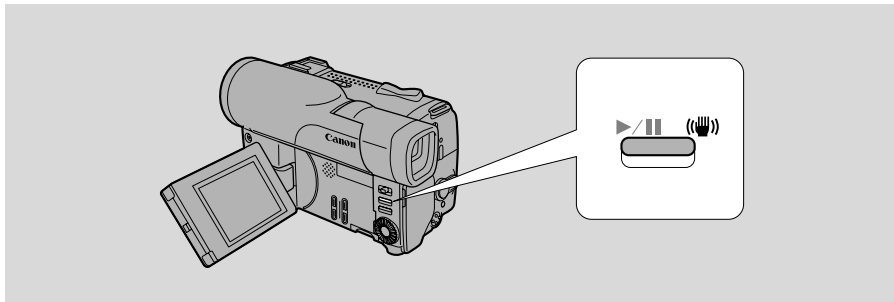

With most camcorders, even the slightest hand movements will be noticeable during telephoto recording. However, the ULTURA's Optical Image Stabilizer allows you to obtain steady recordings even at high magnification. Unlike electronic image stabilizers, it causes no loss of picture quality. The Optical Image Stabilizer can compensate for a wide range of camera movement — you can record stable images even if you are shooting from a moving car.

Before you start recording, push the (👉) on/off button to turn the image stabilizer on or off.

- The (👉) mark appears in the display when the stabilizer is on.
- The image stabilizer cannot be turned off when the POWER switch is set to the (Easy Recording) position.

Notes:

- The image stabilizer is designed to deal with a normal degree of camera shake.
- Keep the image stabilizer turned off when the camera is mounted on a tripod.
- The image stabilizer is not as effective as usual when the tele-converter (optional) is attached.
- The Canon Optical Image Stabilizer system shifts an internal lens to remove camera shake. When the camcorder is turned off, the lens moves freely. This may produce a clicking sound when the camera is moved. This is not malfunction.

Selecting from the Menus

E

Many of the camera's advanced functions are selected from menus which appear in the display.

There are four main menus:

1. **Camera menu (when the camera is in record pause mode: the POWER switch set to or and the standby lever set to MOVIE or PHOTO)**
2. **VCR menu (when the POWER switch is set to VCR)**
3. **Edit menu (when the POWER switch is set to VCR and you select **➡EDIT MODE** from the VCR menu)**
4. **Set up menu (when you select **➡SET UP** from the Edit menu)**

Camera menu (CAM. MENU)

- ① Digital zoomp. 15
- ② 16:9 modep. 47
- ③ White balancep. 56
- ④ Wireless controlp. 30
- ⑤ Tally lampp. 30
- ⑥ Record mode.....p. 14
- ⑦ Audio modep. 48
- ⑧ Wind screenp. 49
- ⑨ Mirror modep. 17
- ⑩ Date/time displayp. 33
- ⑪ Time zone/Daylight saving timep. 31
- ⑫ Date and time setp. 33

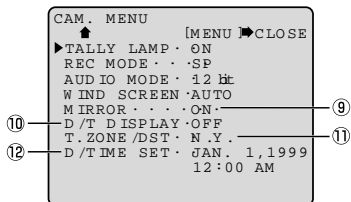
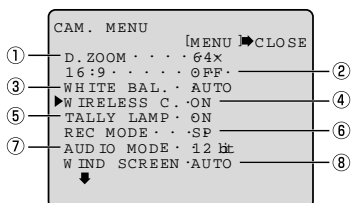

VCR menu

- ① Select edit modep. 60
- ② Wireless controlp. 30
- ③ Record mode.....p. 14
- ④ Select data code displayp. 35
- ⑤ Select date and time displayp. 34
- ⑥ Information displaysp. 94

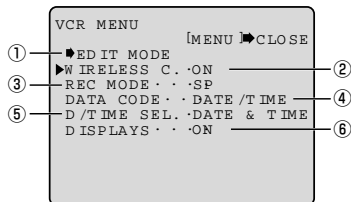

Turn to the appropriate page for a detailed explanation of each function.

Edit menu (EDIT MODE)

- ① Setp. 63
- ② Relocatep. 70
- ③ Deletep. 69
- ④ Previewp. 65
- ⑤ Start.....p. 66
- ⑥ Clear allp. 69
- ⑦ Select set upp. 61

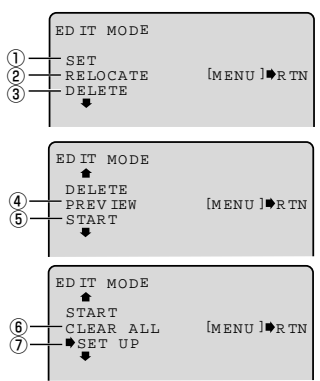

Set up menu (SET UP)

- ① Wireless controlp. 30
- ② Select recorderp. 61
- ③ Cut-in adjustmentsp. 67
- ④ Cut-out adjustmentsp. 67

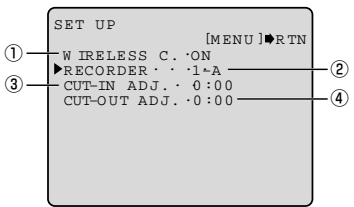

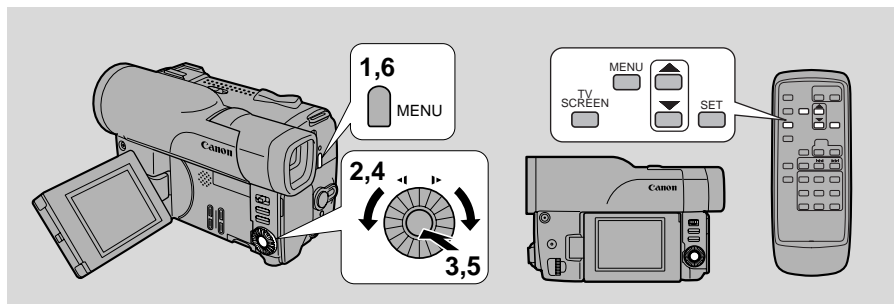

It is convenient to close the LCD screen with its screen side facing up when you select items from the menus. Press the screen until it clicks into place.

- 1. Press the MENU button to open the menu.**
- 2. Turn the command dial to move the arrow up or down the display.**
- 3. Press the set button to select your chosen option from the menu.**
 - Your selected option remains on the screen and all other options are removed.
- 4. Turn the command dial to choose the option setting.**
- 5. Press the set button to select the option setting.**
- 6. Press the MENU button once more to close the menu.**

Notes:

- You can only see eight options on the screen at the same time. Pointers at the top/bottom of the screen indicate that there are more options that you can scroll through.
- You may often find it convenient to use the wireless controller to move around the menus. Press its MENU button to enter/leave the menu and use the cursor keys in place of the command dial.
- You can display the menus on a connected TV screen using the wireless controller's TV SCREEN button.

Using the Wireless Controller/Tally Lamp

E

The supplied wireless controller can operate the camera from a distance of up to 16 feet (5 m). Point it at the camera's remote sensor while you press the buttons.

The tally lamp lights up to let you know that the camera is in range and responding to your commands.

There are five functions which can only be operated using the wireless controller:

- Special playback (p. 21)
- TV-screen displays (p. 94)
- Zero set memory (p. 58)
- Photo/Date search (p. 39)
- 12 bit Audio output (p. 78)

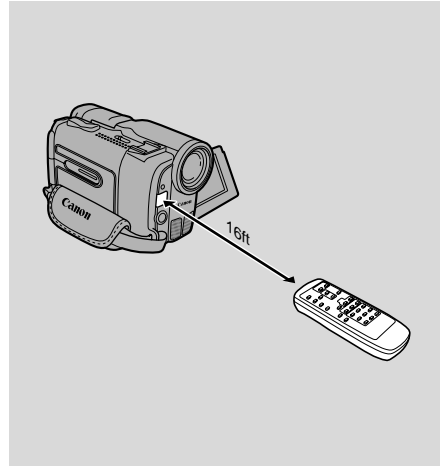

Inserting batteries

Insert two AA batteries, following the ⊕ and ⊖ markings. Be careful not to reverse the polarity of the batteries.

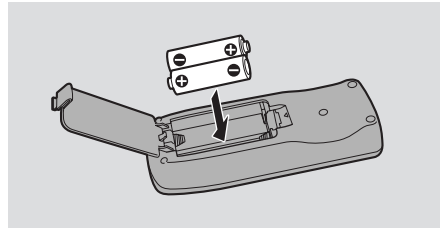

Notes:

- When using the wireless controller in brightly lit places or outdoors, the effective range will be less.
- The camera may have difficulty picking up the remote control signals at extremely close range.
- Do not leave the controller exposed to direct sunlight, or in hot or humid places.
- When the batteries run out, replace both batteries at the same time.

Turning off the wireless controller

The wireless controller can be turned off to prevent interference from other Canon wireless controllers being used nearby.



▶ WIRELESS C. · ON

1. Open either the camera, VCR or set up menu, and point the arrow at **WIRELESS C.**
2. Select the **OFF** setting and close the menu.
 - C **OFF** appears in the display.

Turning off the tally lamp

The tally lamp lets you know that the camera is recording. However, its flashing may be reflected into the lens during close-up recording, or when recording through glass.

You may therefore decide to turn it off.



▶ TALLY LAMP · ON

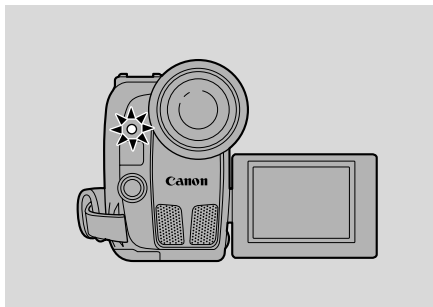

1. Open the camera menu, and point the arrow at **TALLY LAMP.**
2. Select the **OFF** setting and close the menu.
 - The tally lamp no longer flashes during recording, but it will still light up when the camera receives a signal from the wireless controller.

Setting the Date and Time

E

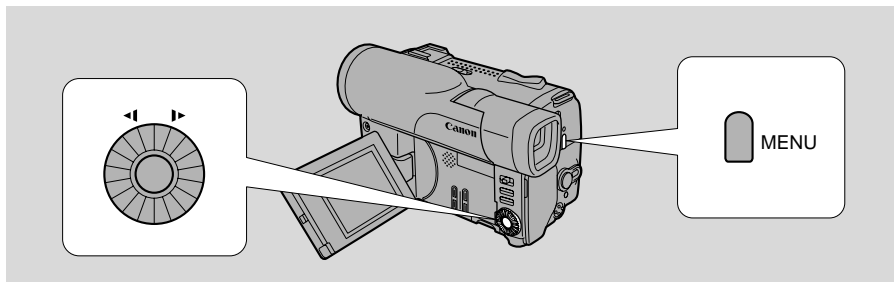

The date and/or time display forms part of the data code. You can choose to display or hide it during playback (see p. 34).

Set the date and time display when you first start using your camera. Install the backup battery before you begin (see p. 76).

- Before you start setting the date and time, select your home time zone from the menu.
- If you are on daylight saving time now, you should set the camera to daylight saving time. You can do this at the same time as selecting your home time zone.
- After you set the date and time, the date/time and home time zone will be displayed for about four seconds each time you turn the power on. Pressing any button makes this display disappear.
- The camera automatically accounts for the number of days in a month and leap year.

Setting the time zone/daylight saving time



MENU
(see p. 26)

▶ T. ZONE / DST · · N. Y.

- 1. Set the camera to record pause mode.**
 - PAUSE appears in the display (see p. 12).
- 2. Open the menu and select T. ZONE/DST.**
- 3. Press the set button.**
 - The time zone display appears on the screen.
 - Your camcorder's time zone is factory-preset to New York. If you are at another time zone, select your time zone first and daylight saving time (DST) setting if necessary.
- 4. Move up or down the list of time zones by turning the command dial and press the set button to select the option that represents your time zone.**
 - If you are now in daylight saving time, select the time zone with the daylight saving time mark  next to the area.
- 5. Press the MENU button.**

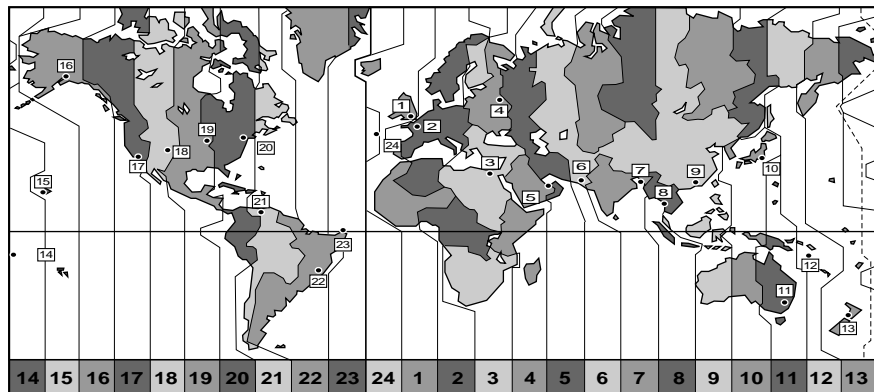

No.	Time zone	No.	Time zone
1	LONDON	13	WELLGTM (Wellington)
2	PARIS	14	SAMOA
3	CAIRO	15	HONOLU (Honolulu)
4	MOSCOW	16	ANCHOR (Anchorage)
5	DUBAI	17	L.A. (Los Angeles)
6	KARACHI	18	DENVER
7	DACCA	19	CHICAGO
8	BANGKOK	20	N.Y. (New York)
9	H. KONG (Hong Kong)	21	CARACAS
10	TOKYO	22	RIO (Rio de Janeiro)
11	SYDNEY	23	FERNAN. (Fernando de Noronha)
12	SOLOMON	24	AZORES

Note:

- After you selected your time zone and set the date and time, when you travel to another time zone, there is no need to reset the date and time. Just set the time zone to your destination and the camera's clock will automatically change to display the correct time for your destination.

Setting the clock

1. **Set the camera to record pause mode.**
 - PAUSE appears in the display (see p. 12).
2. **Open the menu and select D/TIME SET.**
 - The year display starts to flash.
3. **Turn the command dial to change the year. Press the set button to move to another part of the display.**
 - Once you move from the year, the next part of the display starts flashing.
4. **Set the month, day, hour, and minute in the same way.**
5. **Press the MENU button when finished, and the clock starts.**
 - The date can be set to any year between 1999 and 2020.
 - If you press the MENU button in the middle of setting the date and time the seconds are set to zero, you leave the menu, and the clock starts.
 - If you press the set button after setting the minutes you can set the date and time again from the start.

Date and time display

You can choose to display or hide the date and time display during recording. When the date and time display is set to ON, the date and time show in the lower left corner of the display but the time zone disappears in about four seconds. It is not recorded onto your tape.



1. **Turn the POWER switch to record pause mode.**
2. **Open the menu and select D/T DISPLAY.**
3. **Select ON and close the menu.**

Setting the display style

▶D/TIME SEL. •DATE & TIME

1. Press down and slide the **POWER** switch to **VCR**.
2. Open the **VCR** menu and select **D/TIME SEL.**
3. Choose between **DATE**, **TIME** and **DATE & TIME**.
4. Press the **MENU** button to close the menu.

Displaying Data Code

A data code, containing the date and time the recording was made and other camera data (shutter speed and exposure settings) is automatically recorded on a special data section of the tape.

During VCR mode, the data code can be displayed or hidden while the camera is in play, slow or still mode.

Camera data may be displayed as “— — —” during fast forward, rewind, reverse playback, forward and reverse ×2 playback.

Press the wireless controller’s DATA CODE button or the camcorder’s DIGITAL EFFECTS button.

- Press it once to display the data, press once more to hide it.

You can also choose which type of data code to display — either the date/time, camera data or both.

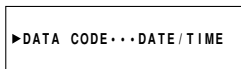

1. Select **DATA CODE** from the VCR menu.
2. Choose between **DATE/TIME**, **CAMERA DATA** and **CAM. & D/T**.
3. Press the **MENU** button once more to close the menu.

Notes:

- To avoid accidental recording, make sure that you slide the tab on the cassette so that it exposes the hole (the switch position is usually labeled SAVE or ERASE OFF).
- The data code will read “— — —” in the following situations:
 - During playback of a blank section of tape.
 - If the tape was recorded before entering the date and time in the camera’s memory.
 - If the tape was recorded on a camera without a data code function.
 - If noise or tape damage prevents the data code from being read.
- Data code is not displayed during high speed playback modes.
- If a recording made on ULTURA is played back on a different DV camcorder, the data code may not be displayed correctly.
- Contents of data code display may change according to D/TIME SEL. (p. 34) or DATA CODE settings made on the menu.

Setting the "Data Code" Setting "Select Date/Time"	Date/Time	Camera data	Date/Time & Camera data
Date	JAN. 1, 1999	F32 1/2000	F32 1/2000 JAN. 1, 1999
Time	12:00:00 AM	F32 1/2000	F32 1/2000 12:00:00 AM
Date & Time	12:00 AM JAN. 1, 1999	F32 1/2000	F32 1/2000 12:00 AM JAN. 1, 1999

- The data code will appear in the display even if DISPLAYS (p. 94) has been set to OFF through the VCR menu.

Taking Still Pictures (Photo Mode)

E

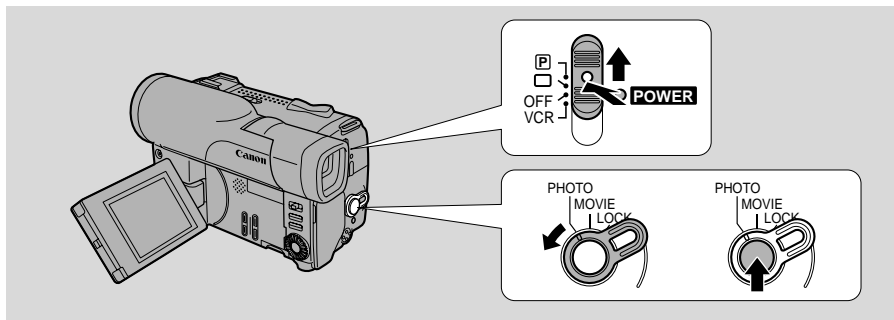

You can record still pictures like a photograph. The camera records the picture to tape for approximately 6 seconds. The exposure is automatically adjusted. You can capture the still images on your computer, enhance or retouch the images and print the images out. (Optional IEEE 1394 computer interface board required.)

1. Set the camera to photo standby mode (slide the POWER switch to (Easy Recording) or , turn the standby lever to PHOTO).

- “PHOTO” is shown at the bottom right of the display.

2. Press the start/stop button lightly.

- **●** flashes white in the display as the camcorder adjusts the focus and exposure and it is displayed continuously as a green mark when the camera is ready to take the still picture. (The focus, exposure, and zoom are now locked. Also, you cannot turn the image stabilizer on /off.)
- To change the still picture before recording: release the button, select a new picture and then press down the start/stop button lightly once more.
- If the subject is unsuitable for autofocus (p. 84), the camera may not be in focus, despite displaying the green mark. In this case: release the start/stop button, adjust the focus manually (p. 52) and retry.

3. Press the start/stop button fully down to take the still picture.

- The camera takes the image almost immediately, and then records the “photo” to the tape for approximately 6 seconds. During this time the camera also records the sound, and the display also shows the still picture.
- A counter display is shown, that counts up to 6 secs as the camcorder records the picture. **●** disappears from the display.

Notes:

- While the camera records the still, you cannot use the camera functions (when a cassette is loaded, standby lever/power off do not cut the power until recording is complete).
- You cannot use digital effects while the camera is set to photo mode.
- You cannot use FlexiZone in photo mode. If the FlexiZone mode is already selected, the camera switches to Auto mode automatically.
- You can also use the wireless controller to take pictures. First, turn the standby lever (on the camera body) to PHOTO. Then use the PHOTO button on the wireless controller. Take the picture with one full push.
- Only take “photos” where it is bright enough to see the image in the display.
- Depending on the subject (fast moving subject, for example), the picture may be blurred.

Searching the Tape (Photo Search/Date Search)

E

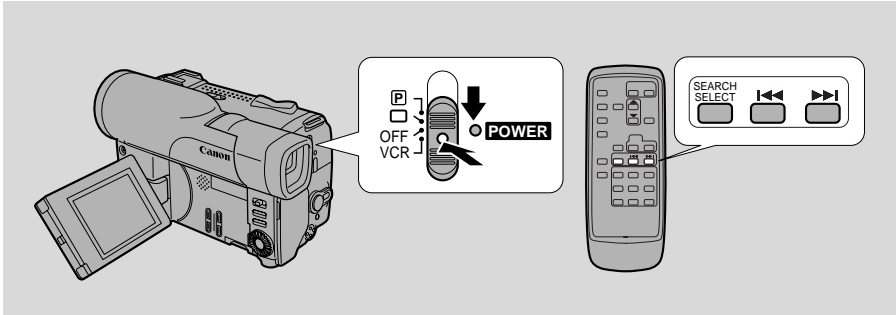

This allows you to move quickly through still pictures recorded anywhere on a tape (photo search) or between different days or areas of recording (date search).

- You can only use this function from the wireless controller.

- 1. Press down and slide the POWER switch to VCR.**
- 2. Press the SEARCH SELECT button to choose between photo/date search.**
 - PHOTO SEARCH or DATE SEARCH is shown in the display for a few seconds.
- 3. Press the ◀◀ and ▶▶ buttons to move backwards or forwards through the still pictures or between different days of recording.**
 - Press once to move to the start of the previous/next still picture or day on the tape.
 - You can press more than once to move to the corresponding still picture or day (up to a maximum of 10 times), e.g. press the ▶▶ button 5 times to move forward 5 still pictures or days.
 - PHOTO SEARCH/DATE SEARCH appears in the middle of the display alongside the ◀◀ or ▶▶ mark and number search through. The recording mode is also shown (SP/LP).

Notes:

- Press ■ (stop) to end your search.
- If you begin a search very close to the start of a recorded still picture during photo search, the camera may skip straight past it.
- When you have set the area for the World Clock, date search also looks for the change in date based on the adjusted time.
- A date/area cannot be identified if the total recording time on that day/area was less than one minute.
- Date search playback may start just before or after the beginning of the located section.
- If the data code is not displayed correctly you will not be able to operate the date search correctly.

Searching and Reviewing While Recording

E

Record search

When the camera is in record pause mode, you can use record search to play the tape forwards or backwards to find the point where you want to start or restart recording. This is useful when you want to add a new scene to a previously used cassette. By using record search, you can ensure a smooth, noise-free join between the new scene and the old one.

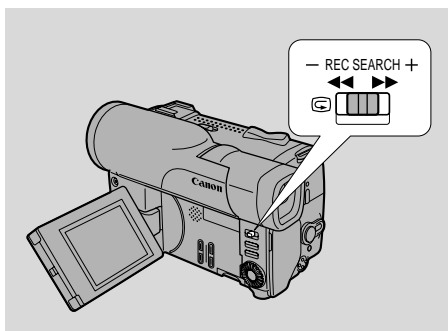

- 1. Make sure the camera is in record pause mode.**
 - PAUSE appears in the display (see p. 12).
- 2. Press and hold the REC SEARCH + or – button while you check the picture in the display.**
 - The + button plays the recording forwards and the – button plays it backwards.
- 3. Release the button when you find the point where you want to start recording.**
 - The camera returns to record pause mode.

Record review

When the camera is in record pause mode, you can use record review to play back the last few seconds of your recording and then return automatically to record pause mode. You can quickly make sure that a scene has recorded properly and then go on to shoot the next scene, without producing any noise in the picture.

- 1. Make sure the camera is in record pause mode.**
- 2. Press and release the  (record review) button while you check the picture in the display.**
 - The camera rewinds the tape, plays back the last few seconds, and returns to record pause mode.

Note:

- Noise (mosaic like noise) may appear on the screen during record search and record review.

Using the Various Recording Programs

E

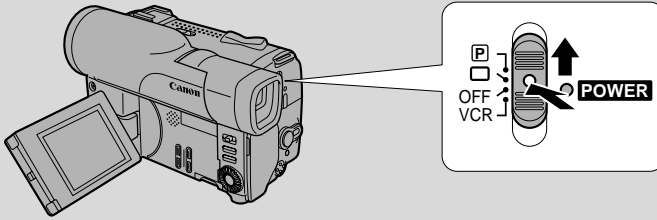

The camera provides you with a choice of eight recording programs. They use different combinations of camera settings in order to adjust the exposure and other functions to match the recording situation.

- For simple point-and-shoot operation, select the Easy Recording program. Slide the POWER switch to the □ position.
- For normal shooting conditions, use the command dial to set the camera (to Auto or FlexiZone).
- For various other recording conditions, the camera has five more specialized AE (auto exposure) programs.

Notes:

- The name of your selected recording program appears constantly on the left of the display, with the exception of the Auto which is displayed and then disappears after 4 seconds.
- Avoid changing programs during recording as the brightness of the image may change suddenly.
- The specialized AE programs are not suitable for all kinds of lighting. The image may flicker, or a bright line may appear on the screen if you use them in the wrong lighting conditions.

Selecting from the program menu

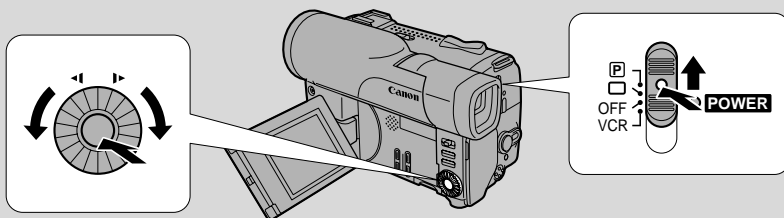

1. Set the camera to record pause mode, with the **POWER** switch set to the **P** position.
2. Press the set button to open the program menu.
3. Turn the command dial to move the arrow up or down the display.
4. Press the set button.
 - The name of the recording program appears in the display.

Note:

- The recording program is reset to **AUTO** when you turn the camera off using the **POWER** switch.

Easy Recording

The simplest way to use the camera is with the **POWER** switch set to the position. The camera will take care of focus, exposure and other adjustments, leaving you free to point and shoot.



If you select this Easy Recording program, you cannot use:

- Exposure lock or compensation
- Different shutter speeds
- White balance set/indoor/outdoor modes
- 16:9 mode
- Digital Effects

Also, autofocus and image stabilization cannot be turned off.

Auto

In normal recording conditions, set the POWER switch to , and choose AUTO from the program menu. This is the same as the Easy Recording program, except that you now have the option of using any of the camera's manual functions — you can adjust focus and exposure, set the white balance, and so on. You can adjust shutter speeds in the Auto Recording program.



FlexiZone

The FlexiZone is the same as the Auto mode except that you can use FlexiZone AF and FlexiZone AE. You can also adjust shutter speeds in this program.

- You cannot use FlexiZone in photo mode.
- If you zoom in to a magnification greater than 64× digital zoom, you cannot use FlexiZone AF or FlexiZone AE (the frame disappears).



Sports

This program is useful for recording high-speed sports scenes in brightly lit conditions. Normal playback will be slightly jerky, but you will get clear images which can be analyzed frame by frame during slow or paused playback.



Portrait

Use this program outdoors to make subjects stand out from a softened foreground and background. It works well for still-lives and close-ups. The effect is most noticeable when the zoom position is between the middle range and the telephoto end. Focus manually for maximum accuracy, and be careful when recording action scenes, as this program may cause fast moving objects to shudder.



Spotlight

This program is designed for recording spotlit scenes, such as on a stage. The exposure is automatically adjusted for glare-free recordings of subjects lit by a concentrated light source.



Sand & Snow

Use this program in places where the background is so bright that the subject appears underexposed in the display — a sunny beach or ski resort, for example. You may notice some shudder when recording moving subjects.



Low Light

This program allows you to record in dimly lit places. It is generally best used for close-ups of slow or stationary subjects, as moving subjects may leave a trailing after-image. However, you can take advantage of this to create special effects, by rapid zooming or by panning along with a moving subject. Picture quality will not be as good as in normal lighting conditions, and autofocus may not work as well as usual.



Using Digital Effects

E

Fade Trigger (FADE-T)

When you start recording, the scene gradually fades in from a black screen. When you stop recording, it gradually fades out.

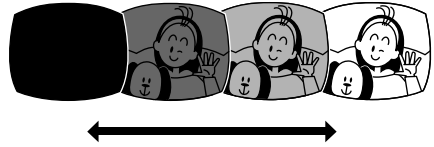

Vertical Wipe (WIPE II)

When you start recording, the picture begins as a thin vertical line in the center of the screen which gradually expands sideways until it fills the whole of the screen. When you end a scene, the image is wiped from both sides of the screen.

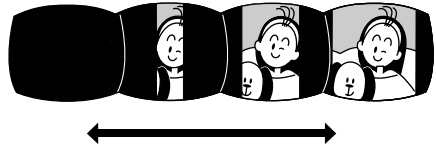

Horizontal Wipe (WIPE III)

When you start recording, the picture begins as a thin horizontal line in the center of the screen which gradually expands upwards and downwards until it fills the whole screen. When you end a scene, the image is wiped from the top and bottom of screen.

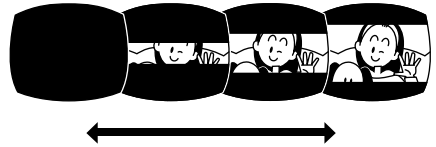

Art (ART)

Adds a paint-like effect, called solarization, to the image.

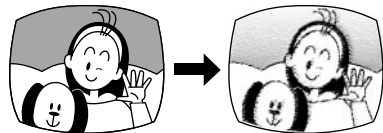

Black and White (BLK&WHT)

Records the image in black and white.

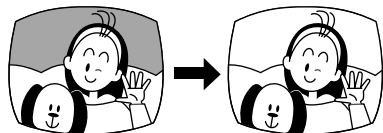

Using the Full
Range of Features

Sepia (SEPIA)

Records a monochrome image with a sepia tint.

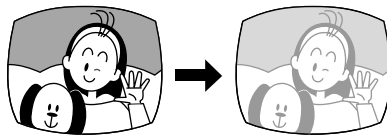

Strobe (STROBE)

This effect converts on-screen action to a series of still images, giving an effect similar to slow-motion.

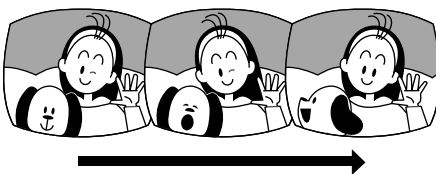

Selecting the effect

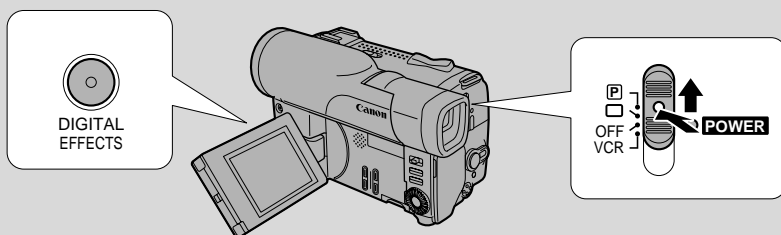

1. Set the camera to record pause mode, with the **POWER** switch set to the **P** position.
2. Press and hold the **DIGITAL EFFECTS** button for more than two seconds to make the digital effects menu appear.
 - The menu appears for four seconds.
3. By pressing the **DIGITAL EFFECTS** button, choose one of the digital effects from the list.
 - As for the Art, Black and White, Sepia and Strobe effects, when you release the **DIGITAL EFFECTS** button, chosen effect is activated and you can see the effect on the display.
 - Each time you press the **DIGITAL EFFECTS** button, the chosen effect is activated or deactivated.
 - To turn the digital effects off completely, choose the **EFFECT OFF** option.

Reactivating the Fade and Wipe Effects

You need to activate the fade trigger and vertical and horizontal wipe effects each time you wish to use them.

- When you start or stop recording, the scene will begin or end with the effect. (Sound and image fade together).
- The display disappears. If you wish to activate it again, press the **DIGITAL EFFECTS** button.

Notes:

- You cannot use digital effects when the camera is set to the (Easy Recording) program.
- You cannot use the fade trigger, vertical wipe or horizontal wipe effects when the standby lever is set to **PHOTO** (its name flashes purple in the display).
- When you activate the fade, vertical wipe or horizontal wipe effect at the beginning of recording a scene, the camera first clears the screen and then applies the effect.
- The camera remembers your chosen effect until you change it, but when you switch the **POWER** switch to (Easy Recording) the digital effect is deactivated.

16:9 mode (Widescreen TV recording)

Produces images in the 16:9 format for playback on widescreen TVs.

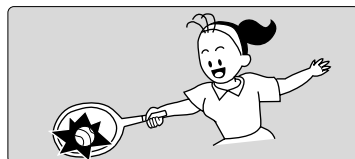
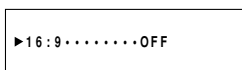

1. Select **16:9** from the camera menu and turn the effect **ON/OFF**.
2. Press the **MENU** button once more to close the menu.

Notes:

- “16:9” is shown in the display when you switch the 16:9 effect on.
- You cannot use the 16:9 mode with the Easy Recording program.
- If you play back a recording made for 16:9 on a normal TV screen, the image will appear to be vertically “squashed” (compressed).

Audio Recording

E

Selecting the audio mode



The ULTURA can record sound in two audio modes — 12 bit (32 kHz, 4 channel) and 16 bit (48kHz, 2 channel). The 12 bit mode records on two channels (stereo 1), leaving two channels free (stereo 2) for you to add new sound at a later date while the 16 bit mode produces the higher sound quality (slightly superior to CD). (If you do plan to add new sound at a later date, make sure you record in SP mode (p. 14).)

1. **To switch the audio mode open the camera menu and select AUDIO MODE.**
2. **Select “16 bit” and close the menu.**
 - The display appears for approximately 4 seconds.

Notes:

- You cannot add new sound to a tape using this camcorder.
- For details of playing back a tape that has new sound on stereo 2, see page 78.

Headphones and external microphone

For greater creative control over audio recording, you can connect an external microphone to the camera's MIC terminal.

You can monitor the sound while recording by attaching stereo headphones to the camera's  terminal.

You can adjust the volume of attached headphones by pressing the volume control buttons.

- A VOLUME bar appears in the display to indicate the current volume.
- The volume control buttons also adjust the speaker volume once you remove the headphones from the headphones socket when the camera is in VCR mode.

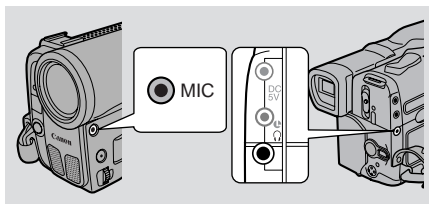

Wind screen

E



▶WIND SCREEN·AUTO

The camera has an automatic wind screen to prevent wind noise from interfering with the sound track. (It does not operate with an external microphone: WS **OFF** is displayed.) Turn it off when you want the microphone to be as sensitive as possible.

1. **Open the camera menu and point the arrow at WIND SCREEN.**
2. **Select the OFF setting and close the menu.**
 - WS **OFF** is shown in the display.

Setting the Self-Timer

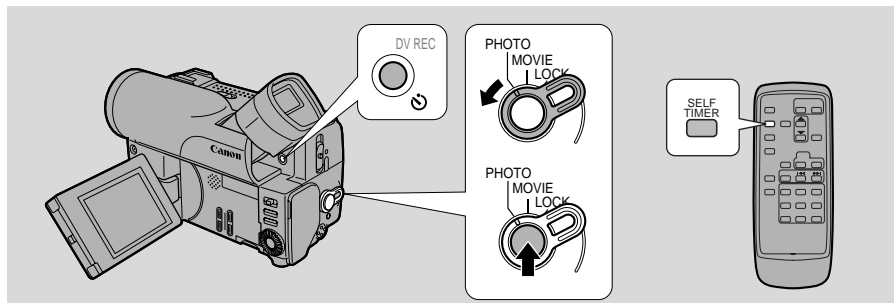

E



This is useful when you want to include yourself in the picture when recording.

- 1. Set the camera to record pause mode.**
- 2. Press the self-timer button “” on the camera body or the SELF-TIMER button on the wireless controller.**
 - SELF T. appears in the display.
 - To have the subject monitor recording, rotate the LCD panel 180° (p. 17).
- 3. Press the start/stop button.**
 - The camera starts to record after a 10-second countdown period (or after two seconds when you use the wireless controller). The time remaining counts down in the display (e.g. “5SEC”).
 - SELF T. disappears from the display when recording begins.
 - The tally lamp starts flashing.
- 4. Press the start/stop button to end recording.**
 - After recording a still picture for about six seconds, the camera automatically goes into record pause mode.

Notes:

- Initially the tally lamp flashes once a second, then more quickly for a few seconds just before the camera starts to record.
- To cancel the self-timer before the countdown has begun, press the SELF-TIMER button again.
- To cancel the self-timer once the countdown has begun, press the start/stop button or the SELF-TIMER button again.
- Cancel the self-timer at any stage by switching the power off or turning the standby lever to LOCK.
- In photo mode, set the self-timer in exactly the same way. The camera automatically adjusts the focus and exposure two seconds before the countdown is complete. The green  mark is also displayed at this time. If you are using the wireless controller, the green  mark is displayed immediately after you press the start/stop button.

Adjusting Focus Manually

E

The camera can focus automatically. All you have to do is point it, and whatever is in the center of the display will usually be in sharp focus. If it does not seem to be focusing well, it may be because the subject is not suitable for autofocus.

It also has two functions which give you more control over focusing.

FlexiZone AF

FlexiZone AF makes autofocus much more powerful. Using the FlexiZone controller, you can select any object that appears in the display, and the camera will bring it into focus.

FlexiZone AF is useful in the following situations:

When your main subject is not in the center of the display.



When you want to shoot a moving subject.



It also makes it easy to use “focus shift” techniques. You can direct the viewer’s attention by focusing first on one part of the scene, and then on another.



1. Choose the FlexiZone recording program.

- The FlexiZone control frame appears in the display.

2. Use the FlexiZone controller to move the frame over the subject.

- The controller can be moved in any direction. Press it repeatedly to move the frame little by little. Press and hold to move the frame quickly.
- The camera adjusts the focus to suit the area inside the frame.

Note:

- You cannot use FlexiZone AF if you zoom in to a digital zoom magnification greater than 64×. The frame disappears and FLEXIZONE appears in purple. The frame reappears in the middle of the screen when you zoom back down.

Focus lock

Press the FOCUS wheel to turn off autofocus. The focus remains locked at the point set by autofocus.

(AF OFF appears in the display.) You can now adjust the focus manually. Press the FOCUS wheel again when you want to return to autofocus.

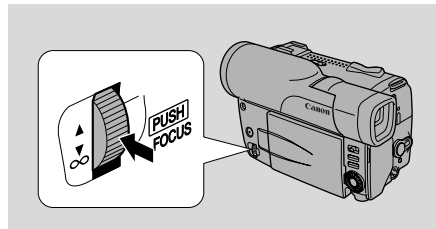

Manual focus

Use the FOCUS wheel to set the focus.

- Turn it downwards (towards ∞) to move the focus further away.
- Turn it upwards to bring the focus nearer.
- If you zoom in on your subject after turning off autofocus, it may not stay in focus. It is generally best to adjust the zoom first, and then the focus.

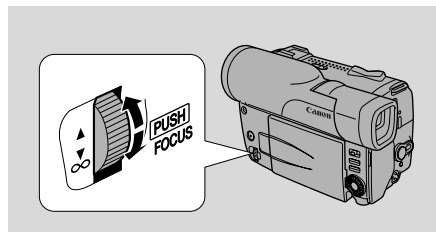

You can also adjust the focus temporarily without turning autofocus off — in this case turn the manual focus wheel to set the focus (without pressing it down) and autofocus will start again as soon as you release the FOCUS wheel.

Notes:

- The manual focus setting is canceled if you:
 - Slide the POWER switch to VCR or OFF.
 - Select the □ (Easy Recording) program.
- When you are using the Easy Recording program, autofocus cannot be turned off, but you can override it temporarily by turning the FOCUS wheel.
- See “Troubleshooting” on p. 84 for a list of subjects which may not be suitable for autofocus.
- You cannot use FlexiZone AF in photo mode.

Adjusting Exposure Manually

E

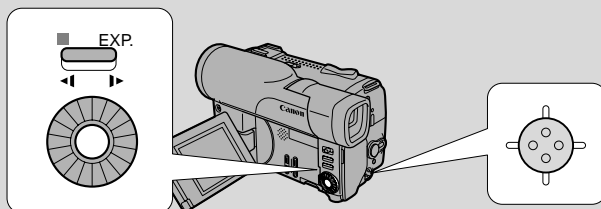

The camera adjusts the exposure automatically, making sure that your pictures are neither too dark nor too light. There is a choice of eight recording programs to deal with different recording conditions (see p. 41).

This section explains how to use three more exposure functions. These will give you added control over your recordings.

FlexiZone AE

The camera attempts to balance exposure for the whole scene. With FlexiZone AE you can choose which area of the scene to base exposure on, to ensure your subject is properly exposed — whether very dark or bright and wherever it is in the frame.



1. Choose the FlexiZone recording program.

- The FlexiZone control frame appears in the display.

2. Use the FlexiZone controller to move the frame over the subject.

- The controller can be moved in any direction.

3. Press the EXP. button to lock the exposure.

- The camera adjusts the exposure to suit the area that is currently inside the frame. You can move the frame to focus on something else, but the exposure area will not move with it.
- E.LOCK appears in the display.

4. Press the button again when you want to cancel FlexiZone AE.

- The exposure is now adjusted to suit the center of the screen again.
- Press the button once more if you want to adjust the exposure for the frame's new position.

Note:

- You cannot use FlexiZone AE if you zoom in to a digital zoom magnification greater than 64×. The frame disappears and FLEXIZONE appears in purple. The camcorder remembers your locked exposure level even though the frame disappears. Push the EXP. button to cancel exposure lock.

Exposure lock

When you are recording in situations where the lighting may change suddenly, you can lock the exposure at the current level in order to control the brightness of the image.

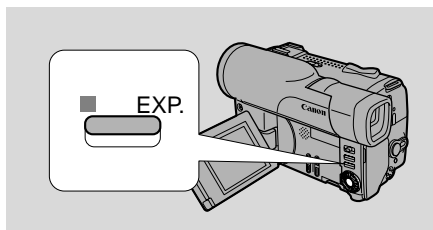

To lock the exposure, press the EXP. button. Press it again to return to the automatically set exposure level.

Exposure adjustment

When the exposure is locked, you can adjust it manually, making the picture brighter or darker in order to deal with difficult lighting conditions, or to manipulate the mood of the scene. The camera's iris can be manually set to any position from fully closed to fully open.

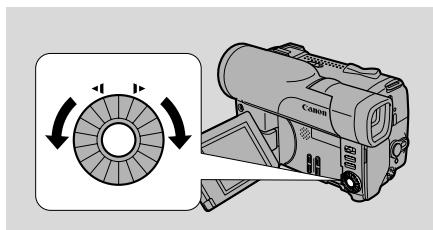

To make the recorded image brighter, turn the command dial clockwise (to a maximum of +11). This may be necessary if the background is very bright, or if the subject is lit from behind.

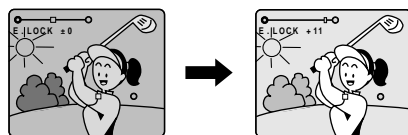

To make the recorded image darker, turn the command dial counter-clockwise (to a maximum of -11). This may be necessary if the background is very dark, or if the subject is spotlighted.

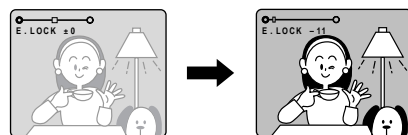

Notes:

- The standard exposure level depends on which recording program you have selected.
- Exposure lock is canceled if you change recording programs.
- You cannot use exposure lock or adjustment when the power switch is set to the (Easy Recording) position.
- If you zoom while the exposure is locked, the brightness of the scene may change.

Shutter speed adjustment

E

You can increase or decrease the shutter speed before you record a scene.

1. **Make sure the camera is set to record pause mode, in the Auto or FlexiZone program.**
2. **Turn the command dial to select the shutter speed.**
 - The selected shutter speed flashes in the display.
 - The indication “1/*” means auto setting.

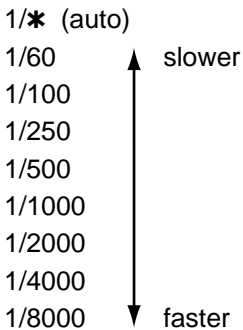

3. **Press the set button.**
 - The shutter speed lights steadily and the camera switches to your selected shutter speed.

Note:

- The camera returns to the auto shutter setting when you slide the POWER switch away from the  setting, or change the recording program.

Concerning shooting in fluorescent lighting



When the camera is set to  (Easy Recording) mode, auto mode or FlexiZone mode, it automatically detects the flicker of fluorescent lighting and adjusts the shutter speed to compensate. However, if the brightness of the LCD or viewfinder display starts to flicker, make sure the camera is set to auto mode or FlexiZone mode and select the 1/100 shutter speed.

Setting the White Balance

E

The camera's auto white balance system compensates for a wide range of lighting conditions. Although slight variations are unavoidable, colors will appear natural in virtually every situation.

In some cases, you will get better results by setting the white balance yourself, or using one of the two preset modes:

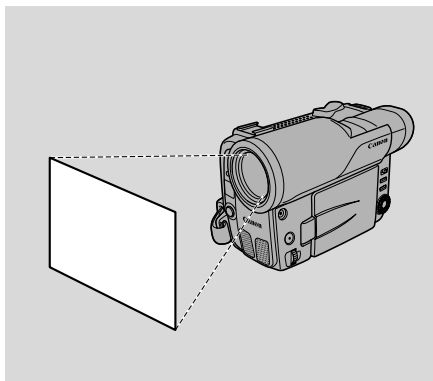

-  Indoor Mode
 - Under halogen or studio/video lighting
 - Subject is of one dominant color
 - Close ups
-  Outdoor mode
 - In daylight, especially for close-ups and where the subject is of one dominant color.



 **MENU**
(see p. 26)

▶WHITE BAL...AUTO

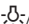
Using the Full
Range of Features

1. **Open the camera menu and point the arrow at WHITE BAL.**
2. **a) For the indoor, outdoor or auto settings simply choose the setting.**
 -  appears in the display when you set the white balance to indoor/outdoor mode.
- b) To set the white balance yourself, point the camera at a white object (such as a sheet of paper) and zoom in until it fills the display, then select SET.**
 - The  display flashes then remains lit.
 - Depending on the light source, the flashing may at times continue. The result will remain better than with the auto setting and you can continue recording.
3. **Close the menu.**

Setting the white balance manually will probably work better than auto white balance when shooting:

Subjects with one dominant color, such as sky, sea or forest



Close-ups



In rapidly changing lighting conditions



In places lit by certain types of fluorescent or mercury vapor lights



Notes:

- Turn the digital zoom off (if necessary) to set a more accurate white balance.
- If the lighting conditions change, reset the white balance by first returning to the AUTO setting, and then reselecting SET.
- Try to record with light from a single source. Correct white balance cannot be obtained for two types of lighting at once.
- You cannot set the white balance or choose the indoor/outdoor mode when the POWER switch is set to the (Easy Recording) program. The camera returns to the AUTO setting when you slide the POWER switch away from the setting.
- When the standby lever is set to LOCK, the current white balance setting remains in the memory.
- If you shoot with studio/video lighting, use the  (indoor) mode.
- During normal outdoor shooting, setting to AUTO may provide better results.

Returning to a Pre-Marked Position

E

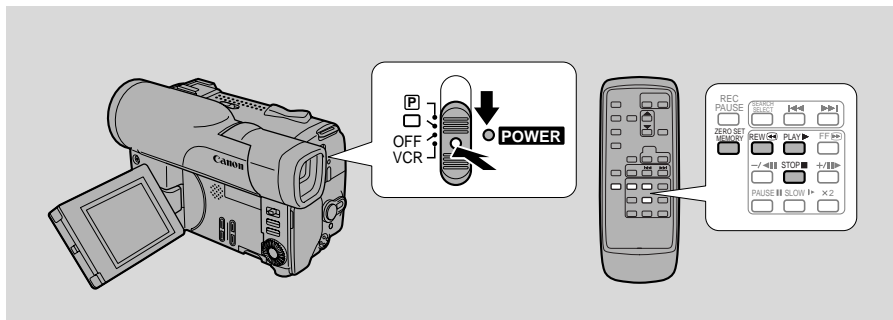

Use the wireless controller to go back to a pre-determined point on a tape following playback.

- 1. Press the ZERO SET MEMORY button during playback at a point you want to return to later.**
 - The time code is replaced by a tape counter that is set to zero with the **M** indication.
- 2. When you have finished playback, fast forward or rewind the tape. The tape stops automatically when it reaches the zero set position.**
 - The tape counter with **M** indication disappears from the display and the time code reappears.

Notes:

- Press the ZERO SET MEMORY button once more to cancel the zero set memory before you forward/rewind the tape.
- The zero set memory may not function correctly where there is a break between recordings on the tape.
- You can also use zero set memory to mark a position on a tape in record pause mode. When you then play back the tape, pressing rewind will take you back to the pre-marked position.
- If you remove the tape while the zero set memory is set, the memory is canceled and the tape counter reverts to timecode.

The Auto Editing Function

Using the Auto Editing Function is simple. Just watch your original tape and press the set button at the beginning and the end of each scene you want to record. This creates an editing program. Start the program, and the camcorder automatically records the scenes you selected onto the tape in your VCR. Before you record, you can preview everything (p. 65), and even delete (p. 69) or re-order scenes (p. 70).

- If you connect another Canon digital video camcorder to the camera instead of a VCR, you can use the Auto Editing Function for digital-to-digital editing, with virtually no generation loss in image and sound quality. However, you cannot set the cut-in and cut-out adjustments using the built-in digital timer (p. 67).

1. Prepare the camera. Connect the video cables, and place it so that it can control your VCR by remote control.
2. Play back the video. When a section of the video you want to keep starts, press the set button. Press the button again at the end of the section you want to keep. You can choose up to 20 scenes this way.

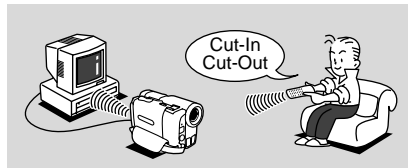

Original tape in Camera

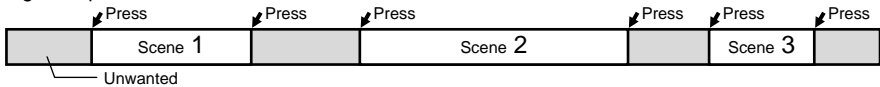

3. If you wish, preview the video. You can also re-order scenes, or even delete them.
4. When everything is perfect, automatically record it to the VCR. Choose START in the menu, then press the set button.

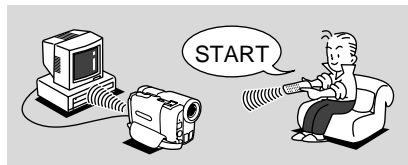
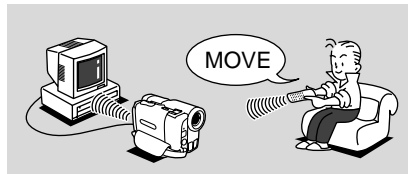

Final tape in VCR

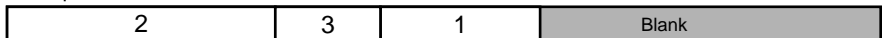

Preparing for Editing

E

The Auto Editing Function enables you to smoothly rerecord scenes from an original tape in any order. You can then view the entire finished product and make all the fine adjustments you want before the final recording. It is easy to reorder, to make your videos perfect.

- 1. Connect the camera to the VCR.**
 - See the “Connections for Playback on a TV Screen” instructions on page 22.
- 2. Turn the TV on.**
 - Be sure to set it to the video channel, or set the TV/Video selector to Video.
- 3. Turn on the VCR and load a blank cassette.**
 - See your VCR instruction manual.
- 4. Open the VCR menu and select \blacktriangleright EDIT MODE.**
 - When you select the edit menu all the displayed information is also displayed on the screen of the TV connected your VCR. However, this information will not be recorded onto the tape in the VCR.

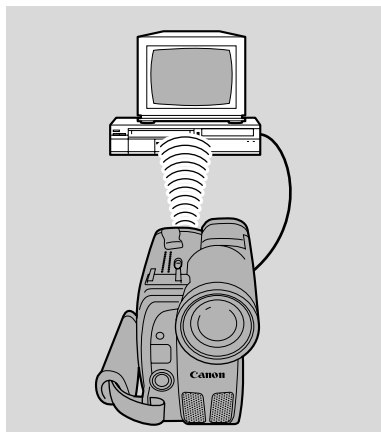

Setting the Camera to Control your VCR

The camcorder's Auto Editing Function controls your VCR by using the same infra-red signals as the VCR's remote control.

Make sure the camera is in a spot where it can remotely control your VCR.

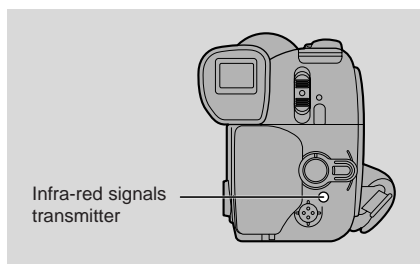

- 1. Check where the remote control sensor is on your VCR using its normal remote control.**
- 2. Place the camera pointing directly at the sensor, not more than 20 inches (50 cm) away.**
 - Check that the sensor will pick up signals easily from this spot using the VCR's normal remote control.
 - Make sure that the cables and the camera strap do not obstruct the signals.
- 3. Make sure that the VCR is in record-pause mode.**
- 4. Make sure that all the other video equipment is turned off to avoid accidental recording.**

Using the Editing Function for the First Time

E

When you use the editing function for the first time, or with a different VCR, you should set your camcorder to send the correct remote control signals to your VCR.

The camera will not forget this setting unless you change it. Do not alter it again unless you change VCRs.

```
SET UP [MENU] ▶ RTN
WIRELESS C. ON
▶ RECORDER . . . 1-A
CUT-IN ADJ. . . 0:00
CUT-OUT ADJ. . . 0:00
```

Preparations & Setting Up

1. **Make sure that the camera and VCR are set up as in “Preparing for Editing,” and “Setting the Camera to Control your VCR,” p. 60.**
2. **Open the set up menu and point the arrow to RECORDER .**
 - It is easiest to view the menu on the TV screen.

Setting RECORDER

Use the chart on p. 62 to find the RECORDER settings for your brand of VCR. Make sure the camcorder’s infra-red control signals can reach the VCR, and the VCR is in record pause mode. (Ready to record and on pause.)

1. **Set RECORDER to the first setting for your brand of VCR.**
 - For example, 7-A if you have a JVC VCR.
 - Turn the command dial clockwise to change the setting.
2. **If the setting is correct, the VCR will start recording automatically.**
 - This will occur as long as the camera is pointing at the VCR’s remote sensor while you change the setting.
3. **If the VCR does not start recording, try the next setting.**
 - Turn the command dial (to 7-B in the above example).
 - Try each setting in turn until the VCR starts to record.
 - During this operation, you cannot operate the wireless controller.
4. **Depending on the brand of VCR, the signals to start and pause recording may differ. Once the VCR starts to record, check that the setting is right.**

Set the VCR to record-pause again, then press the camera’s start/stop button.

- The VCR should start to record for a few seconds, and REC appears in the display and on the TV screen. Then it will automatically pause and PAUSE appears in the display and on screen.
- During these REC, PAUSE operations, the VCR records digital timer, which you will use later for Cut-In and Cut-Out Adjustments. For more accurate adjustments, we recommend you to repeat pressing the start/stop button to record couple of times.
- If not, then the setting is still not right. Try the next setting.

RECORDER

The camera's Auto Editing Function can remotely control almost all brands and models of VCR. VCR remote control signals vary depending on model and brand. First, choose the right RECORDER setting for your VCR. The number indicates the VCR brand. The letter indicates the set of signals.

Brand	Settings	Brand	Settings	Brand	Settings	
Canon	1-A to 1-C	Pioneer	11	Thomson	18-A to 18-C	
Aiwa	2-A to 2-C	Sanyo	12-A to 12-C	Saba		
Akai	3-A to 3-C	Fisher	13-A to 13-C	Nordmende		
Fujitsu	4	Sharp		14-A to 14-F	Ferguson	19-A to 19-C
Funai	5	Sony	15-A to 15-B	Grundig	20-A to 20-C	
Hitachi	6-A to 6-B	Toshiba	16-A to 16-B	Nokia	21-A to 21-C	
JVC	7-A to 7-C	GE	17-A to 17-B	Telefunken	22-A to 22-B	
Mitsubishi	8-A to 8-D	RCA		18-A to 18-C	Zenith	23
NEC	9-A to 9-D	Magnavox	18-A to 18-C	Samsung	24-A to 24-B	
Panasonic	10-A to 10-G	Philips		Seleco	GoldStar	25
Blaupunkt				Rex		
Quasar						

as of August 1999

Notes:

- Once you find the correct setting, remember this and do not change it unless you change VCRs.
- See p. 67 for details of the “cut-in” and “cut-out” adjustments.
- If you try all the numbers and letters, but the VCR has still not started to record:
 - Check the VCR is ready to record, and on pause.
 - Check the VCR can receive signals from where the camera is, and that nothing is blocking the signals.
 - Go back and try to set it again.

- If your brand of VCR is not on the chart, or you cannot find the correct setting, try all the numbers with the command dial until the VCR starts to record.
- It is unlikely, but you may have a VCR the Auto Editing Function cannot control. If so use the Simple Editing method on p. 71.

Choosing a Scene (SET Function)

E

You can put a scene into the editing program by pressing the set button at the point where you want the scene to start and at the point where you want it to end. (The “cut-in” and the “cut-out” points.) Instead of using the controls on the camcorder body, you can use the wireless controller. The ▼ button corresponds to turning the command dial clockwise and the ▲ button to turning it counter-clockwise.

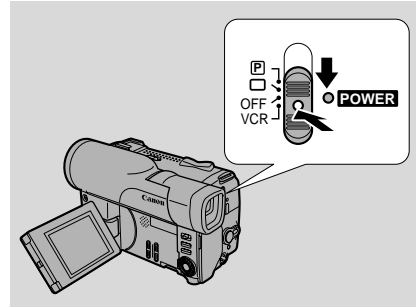

1. **Make sure you have opened the edit menu.**

2. **Choose SET from the edit menu.**

3. **Start the tape with the “PLAY” button: ►.**

- You can use the ►, ◀◀, ▶▶, ||, and ■ buttons or special playbacks in the same way as in playback mode.

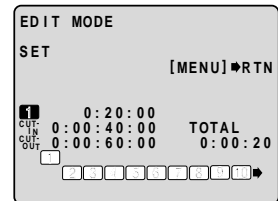

4. **At the start of a scene you want to record, press the set button.**

5. **Press it again at the end of the scene.**

- The beginning and end of the scene according to the counter (the “cut-in” and “cut-out” points) are displayed on the display.
- The programmed number becomes “highlighted”.
- The camera will not let you put in a “cut-in” point later than its “cut-out” point, nor a “cut-out” point earlier than its “cut-in” point.
- You will not be able to make scenes shorter than about two seconds in length.
- You can program only when the counter displays --:--:--.

6. **You can program the Auto Editing Function to remember up to twenty different scenes in the same way.**

Notes:

- TOTAL at the lower right corner of the screen tells you the total running time of all the scenes you have selected.

For best results, when editing from the start of the tape, let the tape run for about 20 seconds according to the counter. Set the first cut-in point after that. Also, avoid setting the last cut-out point in the last three minutes of the tape.

- If you program a cut-in point with no cut-out point following, editing will continue until the tape end and then, the camera and VCR stop automatically.
- Editing a tape recorded in both SP and LP modes may be less accurate.
- Avoid setting the cut-in/cut-out points before non-recorded portions.
- Avoid making the program leaving non-recorded portions between the cuts.
- If, when editing a tape, you set a cut-in point at precisely the start of a still photo (recorded in Photo Mode), the photo search function may malfunction later.

Preview and Recording

E

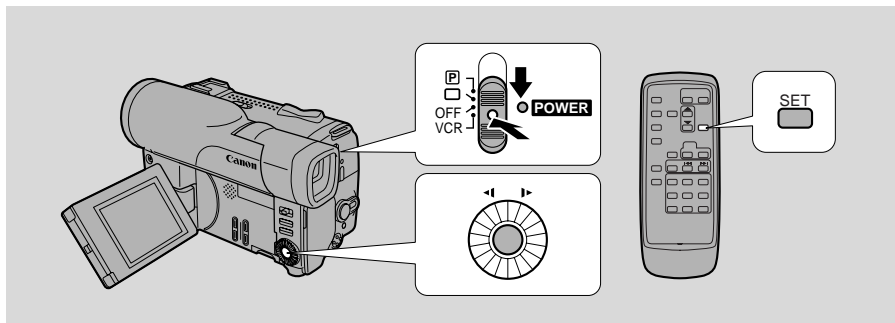

Preview function

You can preview the editing program. The PREVIEW function plays the whole program, automatically pausing at the “cut-in” and “cut-out” of each scene to help editing.

1. Choose PREVIEW from the edit menu and select the program number from which the preview starts by turning the command dial.

2. Press the set button.

- The camera will now play all the scenes from the program number you selected in the order you have programmed them.
- In PREVIEW mode the tape starts a little before each “cut-in” point. It will pause for 2 seconds precisely at the “cut-in” point. It pauses again at the “cut-out” point.
- The program number being previewed is moved up one line.
- When you want to stop the PREVIEW function, press the ■ (stop) button.

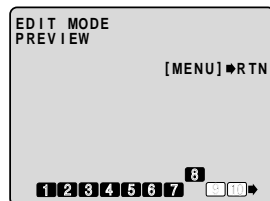

Running the editing program (START function)

1. Make sure the VCR is ready to record and on pause.
2. Choose **START** from the edit menu and select the program number from which you want to start the editing program by turning the command dial.
3. **The editing program starts when you press the set button.**
 - The camera automatically records the scenes you selected onto the tape in the VCR.
 - The Auto Editing Function carries out some operations, such as frame advance at the cut-in/cut-out points, to ensure editing accuracy.
 - When you want to stop editing, press the ■ (stop) buttons on the camera and the VCR.
 - If the Auto Editing Function does not work well, start again from “Choosing a Scene”.

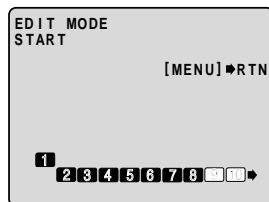

Cut-In and Cut-Out Adjustments

Setting the Cut-In and Cut-Out Adjustments

E

The point where a scene starts is called the “cut-in” point, and the point where it ends is called the “cut-out” point.

Some VCR models take a second or more to actually start recording after they receive the command signal. If this happens you could lose the beginning of the scene. CUT-IN ADJ. prevents this by sending the command a little early.

Similarly, some models take some time to react to the command to stop recording. Some models also rewind slightly after they stop. You could therefore record more than you wanted, or lose the end of the scene. CUT-OUT ADJ. prevents this, by sending the command a little early or late.

If you have these problems with your VCR, reset these adjustments.

Use the set up menu to set the “cut-in” and “cut-out” adjustments.

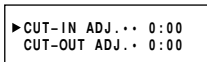

1. Open the set up menu and point the arrow at CUT-IN ADJ.

- Point it at “CUT-OUT ADJ.” to set the cut out adjustment.

2. Adjust the setting.

- CUT-IN ADJ. can be set up to 5 seconds early. (–5:00)
- CUT-OUT ADJ. can be set from one second early to five seconds late. (–1:00 to +5:00)
- This can be set to an accuracy of one frame.

How to calculate the best adjustment for the “cut-in” and “cut-out” points

The tape on which you recorded the digital timer in “Setting RECORDER” is used for calculating the adjustment value.

1. Rewind the tape in the VCR and play back the recorded digital timer.

- Look at the time the CUT-OUT timer stops and CUT-IN timer starts. These times are what the CUT-OUT ADJ. and CUT-IN ADJ. settings should be.
- For maximum accuracy, take an average of at least three readings.
- If your VCR has a frame advance function or a jog dial, you can use it to find the precise starting times more conveniently.

2. Set the CUT-OUT ADJ. and CUT-IN ADJ. settings to the center of the three readings.

Note:

- The camcorder will remember the cut-in and cut-out adjustment settings until you change them.

Deleting Scenes and Clearing the Program

E

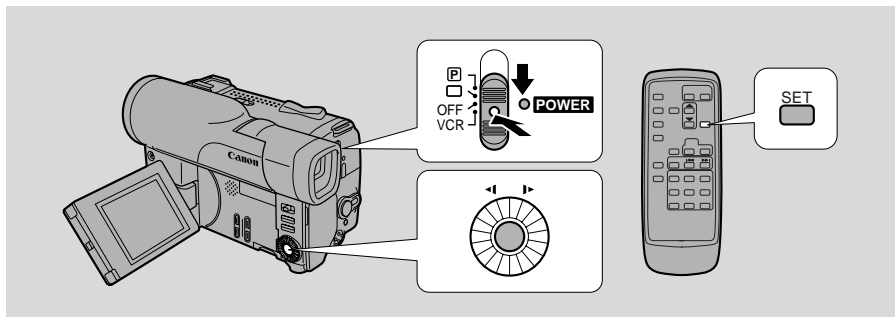

Clearing the whole display (CLEAR ALL function)

This deletes the whole program.

1. Choose **CLEAR ALL** from the edit menu.
2. Press the set button.
 - All the program number indications will return to normal. All data is deleted.
 - Please do not do this by mistake, or you will have to start again from the beginning.

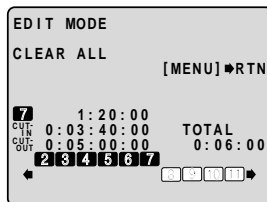

Deleting a scene (DELETE function)

You can delete a scene from the program.

1. Choose **DELETE** from the edit menu and select the program number you want to delete by turning the command dial.
2. Press the set button.
 - The scene is deleted and that program number indication will return to normal.
 - You can insert a new scene here if you wish, using the SET function as described in “Choosing a Scene” on p. 63.
 - If this program number is left unprogrammed, the editing function will stop at this point (the VCR will also stop automatically).

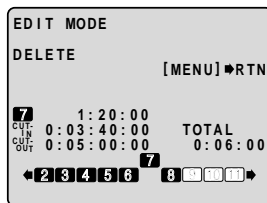

Editing

Reordering Scenes

E

You can move the scenes around and reorder them.

- 1. Choose RELOCATE from the edit menu and select the program number which you want to relocate by turning the command dial.**
 - The selected program number flashes.
- 2. Press the set button.**
 - The selected program number moves one line up.
- 3. Turn the command dial to select the new position.**
- 4. Press the set button.**
 - The program is relocated at the point.
- 5. Repeat as necessary with the other scenes until the program is ordered as you want it.**
 - If a program number is left unprogrammed, the editing function stops at that point (the VCR also stops automatically).

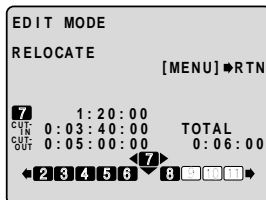

Simple Editing to a VCR

E

If you cannot find the appropriate remote control setting for the camcorder to control your VCR, you still can edit a tape to the VCR as follows.

Preparations

1. **Connect the camera to the VCR.**
 - See “Connections for Playback on a TV Screen” on p. 22.
2. **Prepare the TV and VCR.**
 - Turn on the TV and set it to the video channel, or set the TV/VIDEO selector to VIDEO.
 - Turn on the VCR, and set its input selector to LINE. Load a blank cassette, and put the VCR in record pause mode.
 - See your TV and VCR instruction manuals for details.
3. **Slide the camera’s POWER switch to VCR, and load your recorded cassette.**

Basic editing

1. **Find a point on your recorded cassette slightly ahead of the section you want to copy.**
2. **Start to play it back while you monitor the picture on the TV.**
3. **Start recording on the VCR as soon as the section you want to copy appears on the screen.**
4. **Pause the VCR at the end of the section you want to copy, then stop playback on the camera.**
5. **Repeat steps 1 to 4 until your edited recording is complete.**

Note:

- The quality of the edited tape will be slightly lower than that of the original.

REMOTE terminal

The REMOTE terminal allows you to connect the camera to equipment. Some buttons on editing equipment may operate differently from those on the camera.

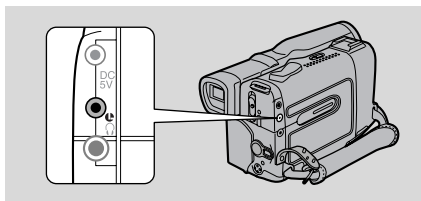

Notes:

- (LANC) is a trademark. It stands for Local Application Control Bus System.
- We cannot guarantee the results when connecting to equipment not bearing the LANC symbol.

DV terminal/connections

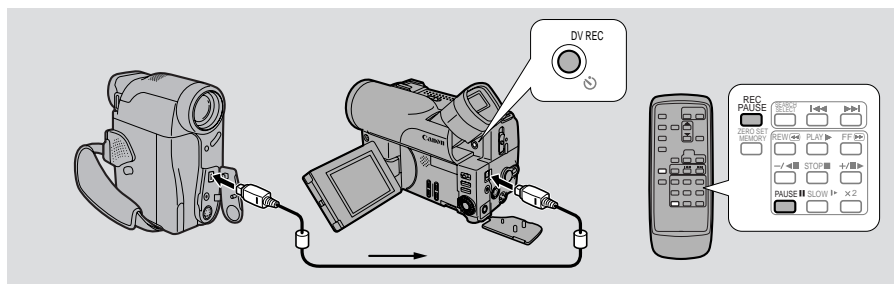

Digital video equipment fitted with this terminal lets you edit, copy and transfer data digitally, with virtually no generation loss in image and sound quality. The DV terminal is for both line-in and line-out, since a single DV cable can handle data in both directions.

- If another Canon digital video camcorder is connected, the Auto Editing Function can be used for digital-to-digital editing (i.e. with virtually no generation loss in image quality).

Use a Canon CV-150F DV cable (optional) to connect two digital devices together. When you are recording, make sure you connect the cable to the ULTURA before connecting the other end of the cable to the recording device. When you are recording to the ULTURA, slide the POWER switch to VCR and press the DV REC button on the ULTURA or the wireless controller's REC PAUSE button ("DV IN" appears in the display when you press "play" on the playback device). Then press its pause button to start/pause recording. If the cables are not connected properly, the camera displays the caution "CHECK THE DV INPUT".

- The image displayed by the camcorder that is being recorded to (for example on its LCD screen, an attached TV, or in its viewfinder) may become distorted during digital dubbing. The actual recording on the tape, however, is not affected.
- If you press the DV REC button with the DV cable unconnected, the camera displays the caution "CHECK THE DV INPUT". An anomalous image may also flash onto the screen.
- Blanks between recordings on the playback tape are recorded as anomalous images on the tape that is being recorded to.
- Do not turn the power off when operating either camcorder with the DV cable connected.

DK-1 DV Capture kit

With the optional DK-1 kit, you can download high quality beautiful still pictures for making cards, calendars, a digital photo album, use on internet home pages, and so on. For full details of how to use the DK-1 DV Capture Kit, refer the DK-1's and computer's instruction manual.

Copyright signal

Certain pre-recorded software tapes are copyright protected. If you try to play back such a cassette, "COPYRIGHT PROTECTED PLAYBACK IS RESTRICTED" appears in the display for a few seconds and then the camera displays a blank blue screen; you cannot view the contents of the cassette. If you try to record from such a tape via the digital cable "COPYRIGHT PROTECTED DUBBING RESTRICTED" appears in the display; you cannot record the contents of the tape.

Preparing the Camera

E

Adjust the viewfinder

- In record pause mode, turn the viewfinder focusing lever (focusing the display) to suit your eyesight.
- The viewfinder rotates to give a choice of shooting positions.

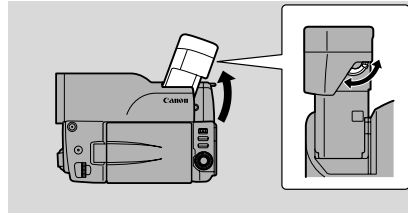

Prepare the lens cap

- Hook the lens cap on to the grip belt while you are recording, and place it over the lens when you have finished.

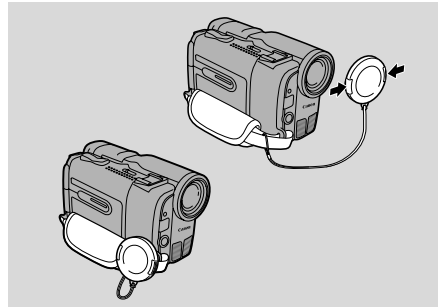

Fasten the grip belt

- Release the Velcro fastening and hold the camera with your right hand while you adjust the belt with your left.

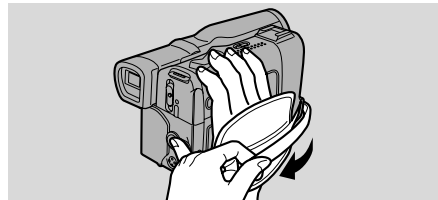

Attach the shoulder strap

- For extra security and portability, attach the shoulder strap before using the camera.
- Pass the ends through the attachment bars and adjust the length as shown.

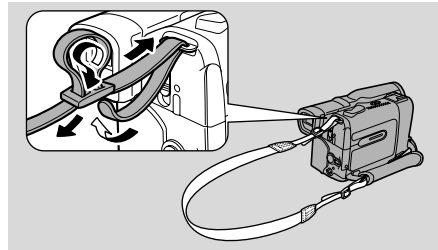

Note:

- Be careful not to leave the viewfinder exposed to bright sunlight, or it will melt. (The light is concentrated by the viewfinder lens.)

Additional Information

Notes on Using the Batteries

E

Charging and recording times

- These times vary — the safest policy is always to have two or three times as many battery packs as you think you will need.
- You will get more recording time if you turn the camera off between shots, instead of leaving it in record pause mode.

Battery pack	BP-915
Time needed for full recharge	2 hr. 40 mins
Maximum recording time	Using the viewfinder: 1 hr. 35 mins Using the LCD screen: 1 hr. 20 mins

- Recording time will be shorter than usual at low temperatures. You can use the battery pack between 32° and 104°F (0° to 40°C), but it works best between 50° and 86°F (10° to 30°C).
- If the battery pack starts to give you much less recording time than usual, it has reached the end of its life and must be replaced.

How much power is left?

The indicator in the display shows you approximately how much charge the battery pack has left:

Notes:

- “CHANGE THE BATTERY PACK ” appears in the display for 4 seconds when the power is completely exhausted. The empty battery mark then appears and starts to flash. The power indicator light also flashes.
- The indicator is not constant — different levels will be shown when you subject the battery pack and camcorder to different conditions.

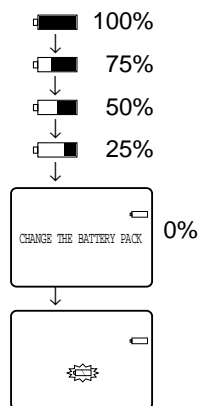

When to recharge

You can recharge a lithium ion battery pack whenever it is convenient. Unlike a conventional battery pack, it does not have to be fully discharged first. However, as the battery pack will naturally discharge itself over time, it is best to charge it the same day you plan to use it, or the day before.

Additional
Information

Taking care of the battery pack

Always attach the terminal cover.

- Do not allow any metal objects to touch the terminals, as this can cause a short circuit and damage the battery pack. Attach the terminal cover whenever the battery pack is not being used.

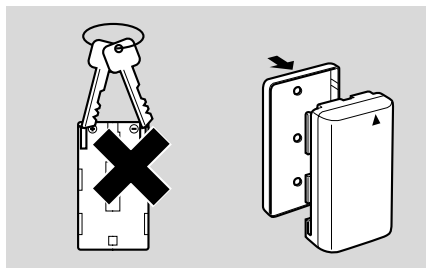

Keep the terminals clean.

- The camera, adapter or battery pack will not work properly if the terminals are dirty. Check them before use, and wipe them with a dry cloth or tissue if necessary.
- If the battery pack is left in the camera, the battery pack will gradually lose power even if the POWER switch is OFF. Remove the battery pack from the camera when the camera is not in use.

Storing the battery pack

- If you do not use a battery pack for a period of more than a few months any remaining charge may cause damage to the battery pack, and reduce usage time. To prevent damage therefore, aim to use a battery pack's complete charge before storage.

Installing the backup battery

Pull out the battery holder from the base of the camera, and insert the CR2025 lithium battery with the + side facing upwards. Click the holder back into place.

- You may find it useful to use a small screwdriver to ease out the battery holder.

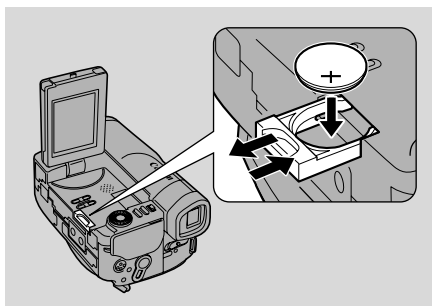

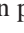
This backup battery allows the camera to remember the date and time and other settings when the main power source is removed. It has a life span of about a year. When it needs replacing (or if it has not been installed), the  mark flashes in the display. Remove the old battery by pushing it down and pulling it out from the left side. Make sure to attach a power source to the camera first, and turn it off using the standby lever. This way it will remember your chosen settings when you change the battery.

DANGER!**Treat the battery pack with care.**

- Keep it away from fire (or it might explode).
- Do not expose the battery pack to temperatures greater than 140°F (60°C). Do not leave it near a heater, or inside a car in hot weather, for example.
- Do not try to disassemble or modify it.
- Do not drop or knock it.
- Do not get it wet.

WARNING!

- The battery used in this device may present a fire or chemical burn hazard if mistreated. Do not recharge, disassemble, heat above 100°C (212°F) or incinerate.
- Replace the battery with a Sony, Sanyo or Panasonic CR2025, or Duracell DL2025. Use of another battery may present a risk of fire or explosion.

Cautions:

- Do not pick up the battery using tweezers or other metal tools — this will cause a short circuit.
- Wipe the battery with a clean, dry cloth to ensure proper contact.
- Keep the battery pack out of reach of children — if it is swallowed, contact a physician immediately, as the battery case may break down and the battery fluids damage the stomach and intestines.
- Do not disassemble, heat, or immerse the battery in water, to avoid the risk of explosion.

Setting the Audio Mix

E

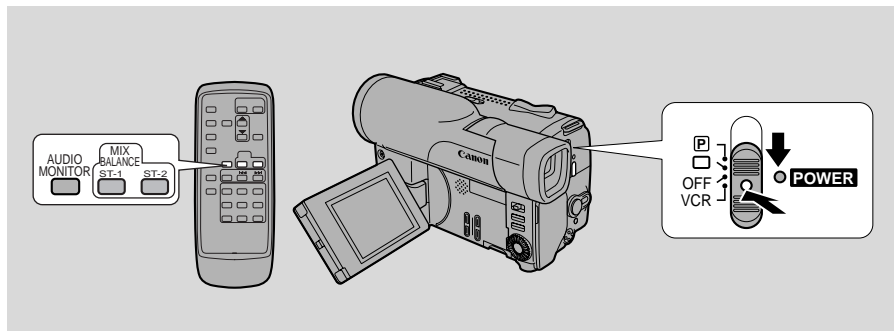

When you play back a tape that was recorded in 12 bit mode, you can set the audio output: stereo 1 (the original sound), stereo 2 (any new sound, dubbed to the tape after recording), or a mixture of the two.

- Audio from the 16 bit mode only contains stereo 1 sound and so you cannot/do not need to select the audio mix. The same is true for the 12 bit stereo 1 mode, unless new sound has been added post-recording.

1. Set the camera to VCR mode.

2. Choose the output.

- Press AUDIO MONITOR on the wireless controller.
- Four settings appear as you push the button:
 - STEREO1 for just stereo 1.
 - STEREO2 for just stereo 2.
 - MIX/FIXED for an equal mix of stereo 1 and 2.
 - MIX/VARIABLE for when you want to mix the balance between stereo 1 and 2.
- To simply choose STEREO1, STEREO2 or MIX/FIXED, make sure your choice appears on the display.
- If you choose MIX/VARIABLE, you can go on to mix the balance.
 - Use the ST-1/ST-2 keys to mix the balance. A bar showing the mix appears on the screen for four seconds.

Note:

- When you have chosen the output, STEREO1, STEREO2 MIX/FIXED or MIX/VARIABLE is shown in the top left of the display for a few seconds. If you turn the power off the output is set to STEREO1.

Maintenance

Cautions

E

Avoid high temperatures and high humidity.

- Do not leave the camera inside a car in hot weather, for example.
- Be careful of heat radiating from video lighting equipment.
- Do not take the camera into a humid room.

Avoid sudden changes in temperature.

- If you take the camera from a cold place to a warm place, condensation may form on the lens and internal parts (see p. 82).

Do not point the lens or viewfinder at strong light sources.

- Never point it at the sun, and do not leave it aimed at a bright subject.
- Be especially careful when leaving the camera on a tripod.

Avoid magnetic or electric fields.

- Do not use the camera close to TV transmitters, portable communication devices or other sources of electric or magnetic radiation. They may cause picture interference, or permanently damage the camera.

Do not expose the camera to water.

- Cover the camera when you are recording in rain or mist.
- There is a risk of electric shock if water gets inside the camera — contact qualified service personnel as soon as possible.

Protect the lens.

- Sand and dust can damage the lens — be especially careful on windy days.

Handle the camera gently.

- Vibration or shock can cause damage.
- Do not use the viewfinder or LCD screen as a carrying handle.

Do not disassemble the camera.

- This is very dangerous as there is a risk of electric shock — if the camera does not function properly, take it to qualified service personnel.

Storage

If you do not intend to use the camera for some time, store it in an area which is free of dust and moisture, and where the temperature is no higher than 86°F (30°C). After storage, check each part and function of your camera to make sure everything is still working properly.

Note:

- These cautions also apply to accessories such as battery packs and cassettes.

Maintenance

LCD screen brightness

- Adjust the brightness of the display if necessary.
- Pressing the ▲ button makes the display lighter, and pressing the ▼ button makes it darker.

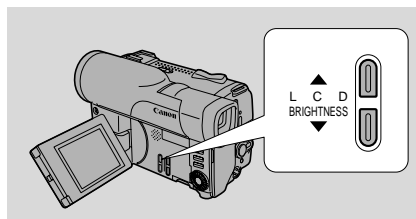

Viewfinder

- Clean the viewfinder screen by inserting a cotton swab through the viewfinder protect cover.

LCD

- Clean the LCD screen using a commercially available glass cleaner.
- Where there is a big change in temperature, moisture may form on the surface of the screen. Wipe clean with a soft, dry cloth.
- At low temperatures the display may appear to be much darker than usual. This is not a fault, and as the screen warms up the display will return to normal.

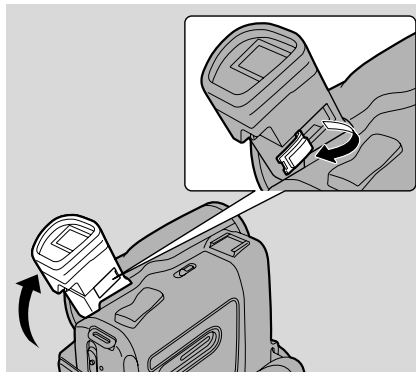

Camera body and lens

- Use a soft, dry cloth to clean the camera body or lens. Never use chemically treated cloth or volatile solvents such as paint thinner.

Video heads

- When mosaic-like noise appears on the playback picture, the video heads may be dirty. When the video heads are badly contaminated, the camera may show a blank blue screen.
- Clean the video heads using Canon's DVM-CL Digital Video Head Cleaning Cassette. If the "noise" remains, repeat the cleaning (up to maximum of five times).
- Do not use a wet-type cleaning cassette, as this can cause damage.



Using the camera abroad

E

Power sources

- You can use the compact power adapter to operate your camera and charge battery packs in any country where the electricity supply is between 100 and 240 V AC, 50/60 Hz. Contact your Canon dealer for information about plug adapters for overseas use.

TV playback

- Although you can always play back your recordings on the LCD screen, your camera can only be connected to TVs which use the NTSC system. This TV system is used in the following countries:
American Samoa, Bahama, Barbados, Bermuda, Bolivia, Canada, Chile, Colombia, Costa Rica, Cuba, Ecuador, El Salvador, Guam, Guatemala, Greenland, Haiti, Honduras, Jamaica, Japan, Korea, Mexico, Micronesia, Myanmar, Nicaragua, Panama, Peru, Philippines, Puerto Rico, Saint Lucia, Surinam, Taiwan, Trinidad and Tobago, USA, Venezuela.

Condensation

Condensation may form on the camera when it is moved from a cold place to a warm place. Using the camera while condensation is present can damage both the tape and the camera.

Condensation may become a problem:

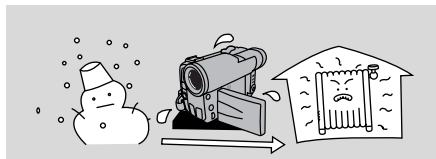

When you bring the camera from a cold place to a warm room

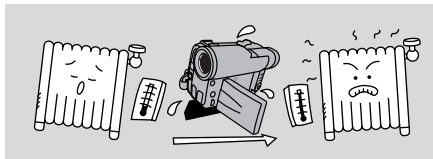

When a cold room is heated rapidly



When the camera is left in a humid room

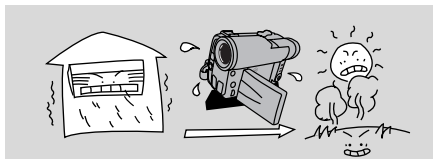



When the camera is taken from an air-conditioned room to a warm, humid place

Protecting the camera from condensation

- Before you bring the camera to a warm or humid place where condensation is likely to be a problem, unload the cassette and put the camera in a plastic bag. Wait until the camera reaches room temperature before you take it out of the bag.

What happens when condensation is detected

- “CONDENSATION HAS BEEN DETECTED” is displayed for approximately 4 seconds. Then, the power indicator flashes and the  mark flashes in the display. If there is a cassette in the camera, it stops automatically and “REMOVE THE CASSETTE” is displayed for approximately 4 seconds and then  flashes in the display.
- The camera may not detect the condensation immediately — the condensation warning may not start flashing for 10 to 15 minutes.
- You cannot load a cassette when condensation is detected.

What you should do

- Remove the cassette, leave the cassette compartment open, and turn the camera off.
- Leave it in a dry place until the condensation evaporates. After the condensation warning stops flashing, wait at least another hour before trying to use the camera.

Troubleshooting

E

Refer to this checklist first if you have any problems with your camcorder. Possible explanations are given for each problem on the list — turn to the page numbers in parentheses for more information.

Make sure that the camera is properly connected if you are using it with a TV or VCR. Consult your dealer or service outlet if problems persist.

Recording/Playback

Problem	Cause and/or what to do about it
? Nothing happens when I press the buttons.	<ul style="list-style-type: none">• The camera is not switched on (p. 12, 19).• The cassette is not loaded or is set for erasure prevention (p. 10-11).• The tape has reached the end.• The battery pack is exhausted or not properly attached (p. 8, 9, 75).• The function cannot be used in that recording program (p. 41).
? The camera turned itself off.	<ul style="list-style-type: none">• The camera was in record pause mode for more than about five minutes (p. 12).• The battery pack is exhausted (p. 9).
? The start/stop button doesn't work.	<ul style="list-style-type: none">• The POWER switch is not set to <input type="checkbox"/> or <input checked="" type="checkbox"/> (p. 12).• The standby lever is set to LOCK (p. 12).• The cassette is not loaded or is set for erasure prevention (p. 10-11).• The tape has reached the end.
? There's no picture in the display.	<ul style="list-style-type: none">• The POWER switch is not set to <input type="checkbox"/> or <input checked="" type="checkbox"/> (p. 12).• The standby lever is set to LOCK (p. 12).
? There's a blank blue screen in the display.	<ul style="list-style-type: none">• You are attempting to play back or record from a copyright protected cassette (p. 73).• The video heads are very dirty (p. 80).

❗ The camera won't focus.

- The camera is on manual focus (p. 51).
- The viewfinder lens needs adjusting (p. 74).
- The lens is dirty (p. 80).

Note:

- Some subjects are not suitable for autofocus. In these situations, you will often get better results using manual focus. In these situations, you will often get better results using manual focus (see p. 51). Focus on something which is about the same distance away, lock the focus, and then point the camera at your original, hard-to-focus subject.



Horizontal stripes



Many subjects at different distances



Behind glass

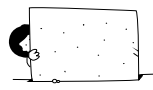

Without much contrast (e.g. a white wall)



Reflective surfaces (e.g. shiny car surfaces)



Fast moving objects



Slanted subjects



Dark subjects



Night scenes

Recording/Playback (Contd.)

Problem

❗ The digital effects don't work.

❗ The ► (play) button doesn't work.

Cause and/or what to do about it

- There are a number of restrictions on using the digital effects. Refer to the notes on p. 47.
- The POWER switch is not set to VCR (p. 19).
- The cassette is not loaded (p. 10).
- The tape has reached the end.

- ❓ **There's a bright stripe on the screen.**
 - When recording in dark places a bright light in the scene may cause a vertical light bar ("smear") to appear. This is a normal feature of camcorders.
- ❓ **The playback picture is rough (with mosaic-like noise).**
 - The video heads need cleaning (p. 80).
- ❓ **There's no picture on the TV screen, even though the tape is moving.**
 - The video heads need cleaning (p. 80).
 - The TV/VIDEO selector on the TV isn't set to VIDEO (p. 22).
- ❓ **There's no sound coming from the speaker during playback.**
 - The volume control is switched off (p. 18).
 - Headphones are being used.

Miscellaneous

Problem

Cause and/or what to do about it

- ❓ **The wireless controller doesn't work.**
 - It is turned off (p. 30).
 - The batteries are dead or not inserted.
- ❓ **The tally lamp doesn't flash.**
 - It is turned off (p. 30).
- ❓ **The power indicator is flashing.**
 - Check the screen displays (p. 75).
- ❓ **The camera malfunctions.**
 - External interference may cause the camera's microprocessor to malfunction temporarily. If random letters appear in the display or if normal operation is interrupted, remove and then replace the power source (and if necessary, the back-up battery).
- ❓ **The DV cable is connected correctly, but there's nothing in the display.**
 - Remove the cable and then reconnect it or turn the power off and back on again.

The ULTRA System Diagram

(Availability differs from area to area)

E

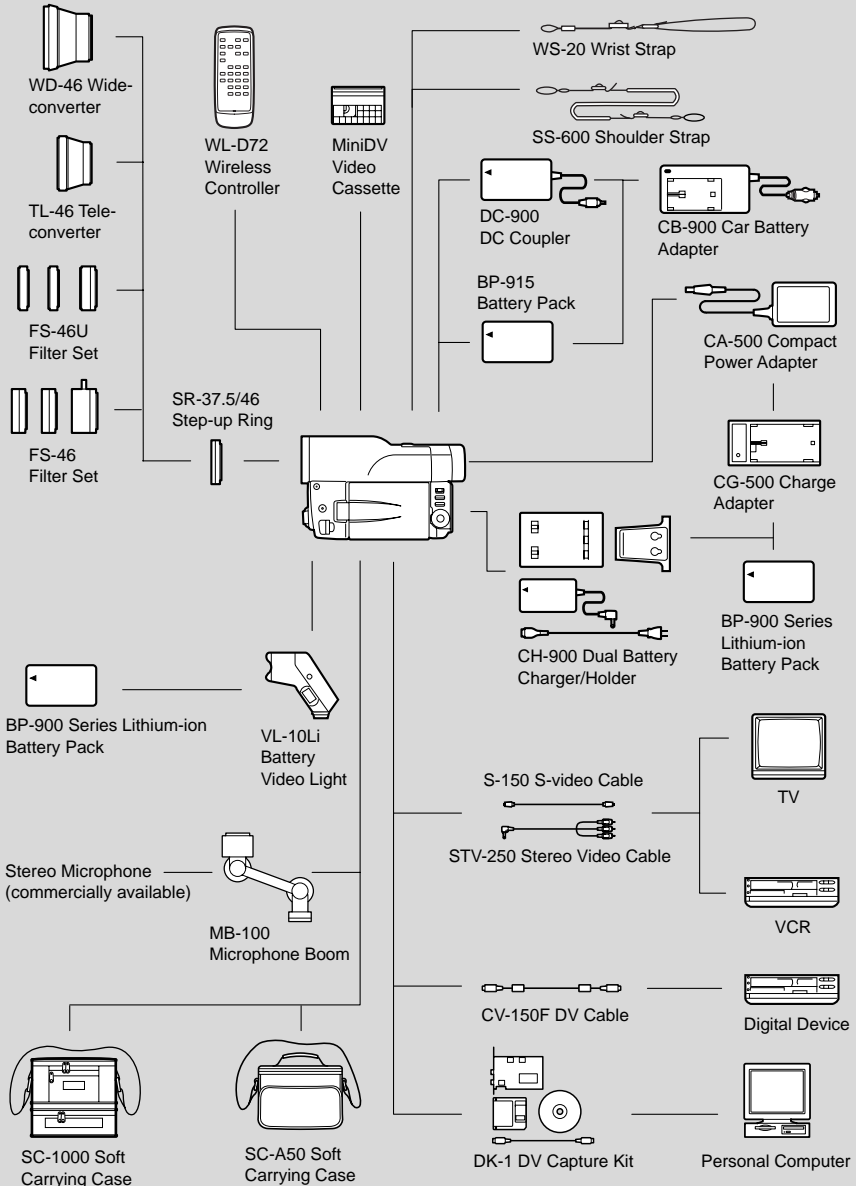

Additional Information

Optional Accessories

E

Call or visit your local retailer/dealer for genuine Canon video accessories. You can also obtain genuine accessories for your Canon camcorder by calling: 1-800-828-4040, Canon U.S.A. Information Center.

Battery pack

Extra battery for use with the ULTURA.

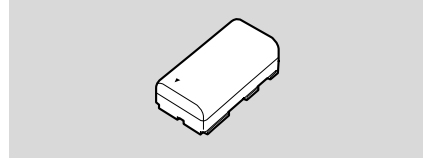

Battery pack	Maximum recording time		Playback time (using the LCD screen)
	using viewfinder	using LCD screen	
BP-915 (supplied)	1 hr. 35 min.	1 hr. 20 min.	1 hr. 40 min.
BP-914 (optional)	1 hr. 25 min.	1 hr. 15 min.	1 hr. 30 min.
BP-927 (optional)	2 hr. 50 min.	2 hr. 30 min.	3 hr.
BP-930 (optional)	3 hr. 10 min.	2 hr. 40 min.	3 hr. 20 min.
BP-941 (optional)	4 hr. 10 min.	3 hr. 40 min.	4 hr. 30 min.

Battery pack	Time required for full charge
BP-915	2 hr. 40 min.*/3 hr. 10 min.**
BP-914	2 hr.*/3 hr. 10 min.**
BP-927	3 hr. 50 min./5 hr. 20 min.**
BP-930	4 hr./5 hr. 40 min.**
BP-941	6 hr. 30 min./8 hr. 50 min.**

* When using the CA-500 Compact Power Adapter

**When using the CG-500 Charge Adapter

The optional CH-900 Dual Battery Charger/Holder is required to charge/use the battery packs in the shaded area. When you attach two battery packs to the CH-900, the maximum recording time will be almost doubled.

The playback time figures show how long you can view playback with the LCD, after attaching a fully-charged battery pack. Playback time will be shortened at low temperatures.

CB-900 Car Battery Adapter

Power your camera, or recharge battery packs on the move. The car battery adapter plugs into your car's cigarette lighter socket and runs off a 12–24 V DC negative ground battery.

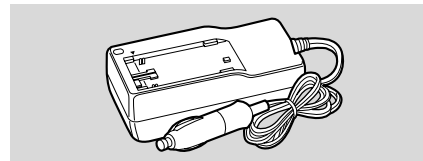

CG-500 Charge Adapter

When used with the CA-500 Compact Power Adapter, this adapter can charge the BP-900 series lithium ion battery packs.

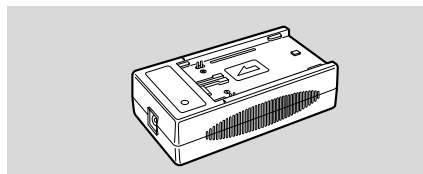

SR-37.5/46 Step-up ring

This makes it possible to use the 46 mm filters and converters (shown below) with ULTURA. When you attach the filter or conversion lens, you cannot use the supplied lens cap.

**TL-46 Tele-converter**

This tele-converter lens increases the focal length of the camera lens by a factor of 1.4. The zoom and autofocus operate as usual, so you can take full advantage of the extra range.

- The image stabilizer is not as effective as usual when the tele-converter is attached.

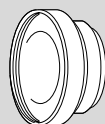
**WD-46 Wide-converter**

This lens decreases focal length by a factor of 0.7, giving you a wide perspective for indoor shots or panoramic views.

- There may be some vignetting at the extreme wide angle position.

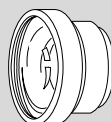
**FS-46 Filter Set**

Three special effects filters to add a creative touch to your recordings: multiple-image, R-cross and zoom-spot.

- Focus manually when using special effects filters.
- There may be some vignetting when using special effect filters.

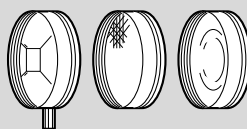
**FS-46U Filter Set**

Ultraviolet, neutral density and circular polarizing filters to help you take control of difficult lighting conditions.

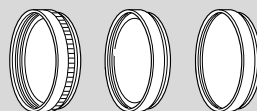

VL-10Li Battery Video Light

This compact yet powerful video light can be used for both indoor and outdoor shooting.

- Lithium ion battery packs can be used to power the light. Approximate usage times are as follows:
 BP-914 50 min BP-927 100 min
 BP-915 60 min BP-930 120 min
 BP-941 160 min

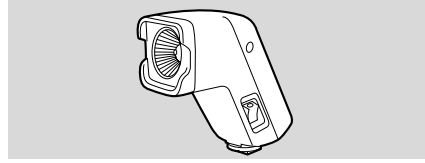

WS-20 Wrist Strap

Provides an extra measure of protection for active shooting.

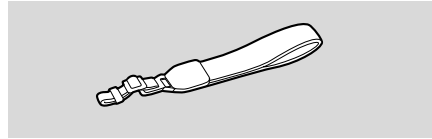

MB-100 Microphone Boom

Provides a firm, flexible support for the microphone, so you can take full advantage of the sound quality and creative control it offers.

- A long microphone may be visible in the picture. To avoid this, use the MB-100 Microphone Boom.

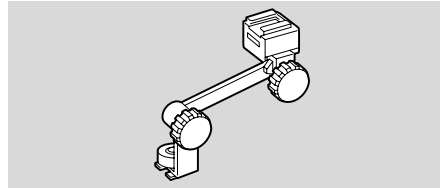

CH-900 Dual Battery Charger/Holder

This holds two battery packs and can charge them both consecutively. It can then be connected directly to the ULTURA to give twice the playback time. It can also make use of the higher performance battery pack BP-941, to give up to 8 hrs. 20 mins. recording time.

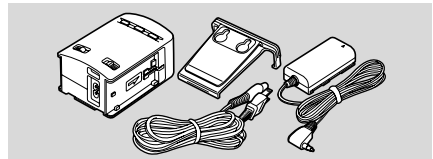

SC-1000 Soft Carrying Case

A handy camera bag with padded compartments and plenty of space for accessories.



SC-A50 Soft Carrying Case

This lightweight bag keeps the camera within easy reach without weighing you down or getting in the way. Genuine leather.



DK-1 DV Capture Kit

It contains Adaptec IEEE 1394 interface board AHA8940, Adaptec IEEE 1394 Software, Canon DVCommander, Canon DV TWAIN Driver and MGI PhotoSuite. You can capture the still pictures from the ULTURA on your computer. For use with Windows 95/98.

- Adaptec, AHA are trademark of Adaptec, Inc./MGI PhotoSuite is a trademark of MGI Software Corp./Windows is a registered trademark of Microsoft Corporation.

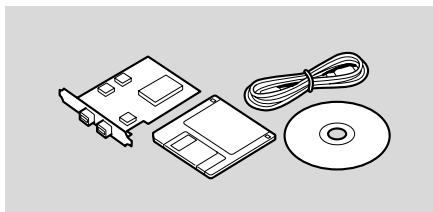

This mark identifies genuine Canon video accessories. When you use Canon video equipment, we recommend Canon-brand accessories or products bearing the same mark.

Provided accessories:

WL-D72 Wireless Controller	D83-0512-000
CA-500 Compact Power Adapter	D85-0892-201
BP-915 Battery Pack	D85-0952-201
SS-600 Shoulder Strap	D81-1330-000
S-150 S-video Cable	D82-0330-202
STV-250 Stereo Video Cable	D82-0516-000
Lens cap	D52-0090-000
DVM-E30 Digital Video Cassette	D36-0012-000

Optional accessories:

CB-900 Car Battery Adapter	D85-0502-201
CH-900 Dual Battery Charger/Holder	D85-0772-201
CG-500 Charge Adapter	D85-0890-201
BP-914 Battery Pack	D85-0842-201

BP-927 Battery Pack	D85-0852-201
BP-930 Battery Pack	D85-0962-201
SC-1000 Soft Carrying Case	D81-1200-001
SC-A50 Soft Carrying Case	D81-1302-201
WD-46 Wide-converter	D78-0013-201
TL-46 Tele-converter	D78-0014-201
FS-46U Filter Set	D78-0008-201
FS-46 Filter Set	D78-0006-201
VL-10Li Battery Video Light	D86-0081-201
JR7.2V 10WF Halogen Bulb	DY4-4530-000
MB-100 Microphone Boom	D89-0200-202
SR-37.5/46 Step-up Ring	D56-0060-201
WS-20 Wrist Strap	D81-0190-202
DVM-CL Digital Video Head Cleaning Cassette	D36-0032-201
DK-1 DV Capture Kit	D80-5032-201

Finding Your Way Around ULTURA

E

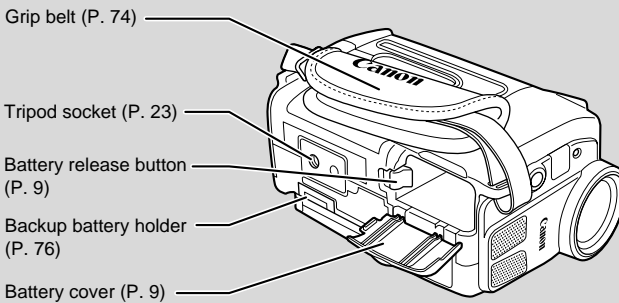
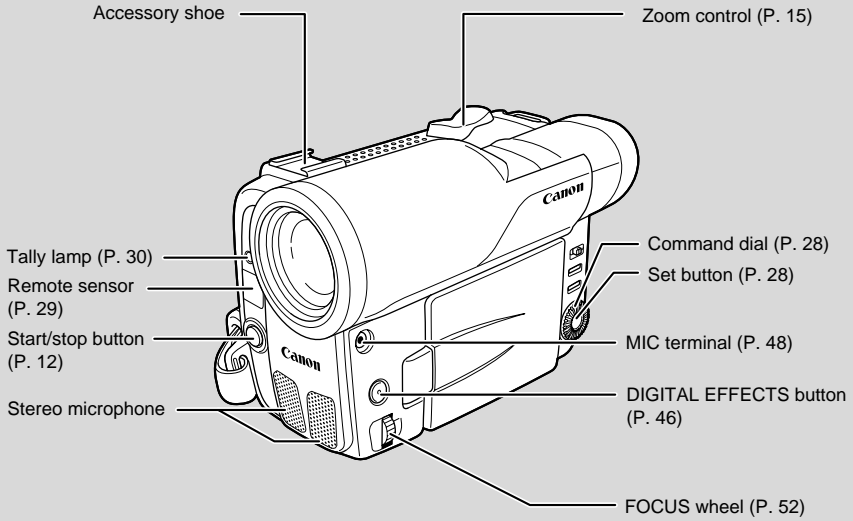

Additional
Information

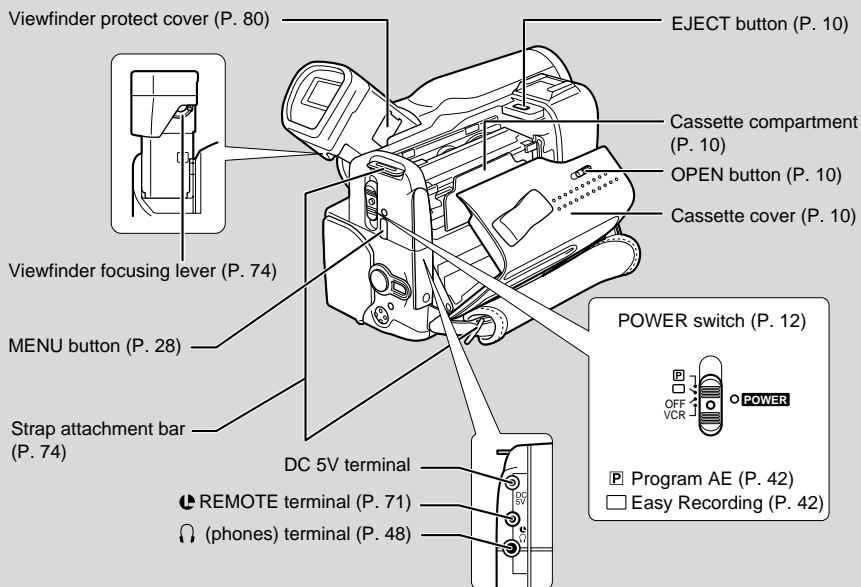
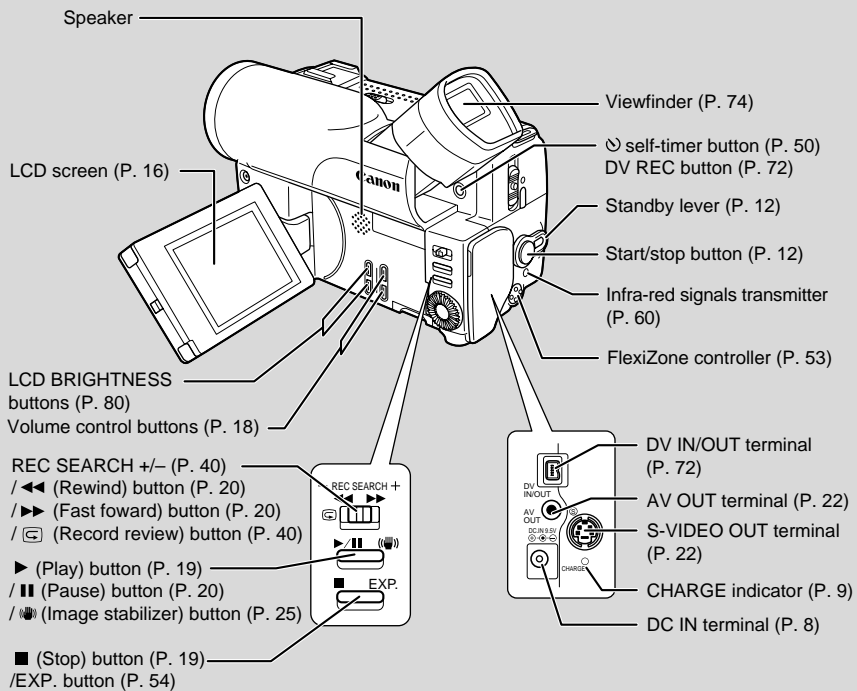

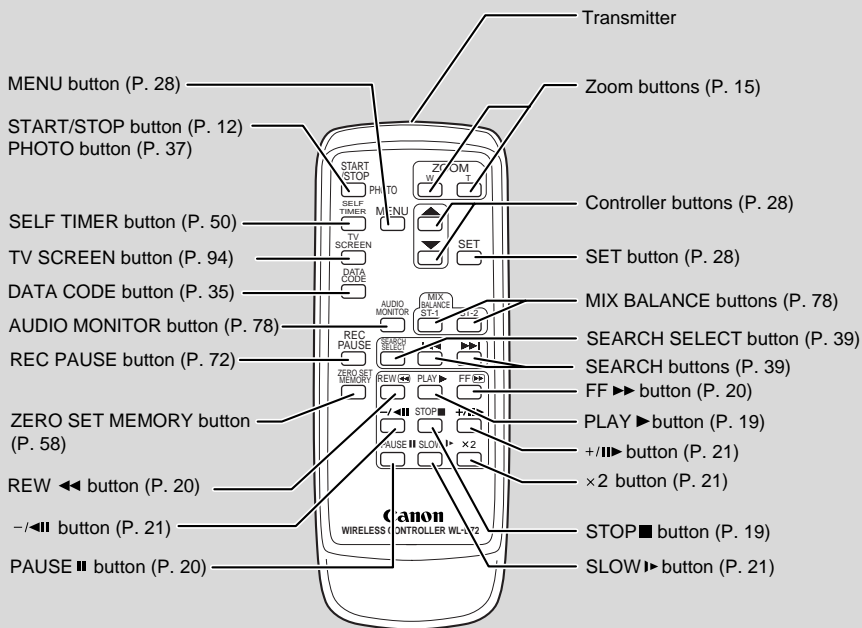

Screen Displays

E

To display the date and time on a connected TV, press the wireless controller's DATA CODE button.

Press the wireless controller's TV SCREEN button to see the other displays on the TV screen. (The displays appear white on-screen.) They will not be added to any recordings you make with the camera.

 indicates a flashing display.

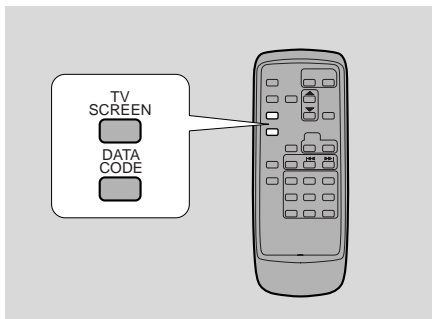

Turning off the LCD screen displays

You can turn off the displays to give you a clear screen for playback.

Set the camera to VCR mode, open the VCR menu (page 26) and choose the DISPLAYS option. Set the displays to OFF <PLAYBK> and then close the menu.

- The LCD screen will now be completely blank, but the camera will continue to show warning/caution displays when necessary.

Record pause mode (p. 12)



Recording (p. 12)



The backup battery is not properly installed, or needs replacing (p. 76).



Shows how much battery power remains (p. 75).



The battery pack is exhausted (p. 9, 75).



No cassette is loaded, or it is set for erasure prevention (p. 10, 11).



Remaining tape (Green: more than 5 mins.

Yellow: less than 5 mins.

Red: final few secs).



...finally, it tells you when you have completely run out of tape.



The camera is ejecting the tape (p. 10).



The safety mechanism is activated. Unload the cassette and turn the camera off. Turn it on again and reload the cassette.



Recording mode (p. 14)

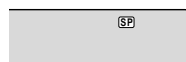

Playback is stopped (p. 19).



Normal playback
(p. 19)

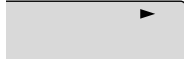

Fast forward (p. 19)



Rewind (p. 19)



Fast forward playback
(p. 20)



Rewind playback
(p. 20)



Frame advance
playback (p. 21)



Frame reverse
playback (p. 21)



Playback pause
(forward and reverse)
(p. 20)

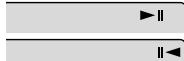

Slow playback
(forward and reverse)
(p. 21)

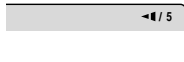
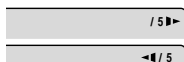

×2 playback (forward
and reverse) (p. 21)

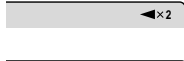

×1 playback (forward
and reverse) (p. 21)



Photo Search
(p. 39)



Date Search
(p. 39)



Zoom display (p. 15):
Optical zoom



Optical plus 64×
digital zoom

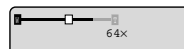

Optical plus 320×
digital zoom



Zoom in

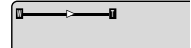

Zoom out

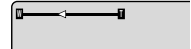

The image stabilizer is
turned on (p. 25).



Camera menu (p. 26)

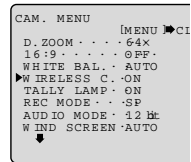

VCR menu (p. 26)

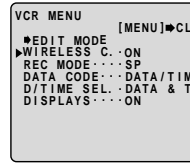

Edit menu (p. 27)

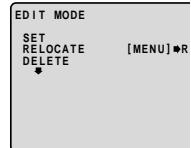

Set up menu (p. 27)

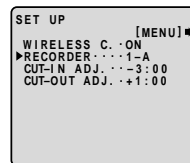

The wireless controller
is turned off (p. 30).



Self-timer countdown
(p. 50)

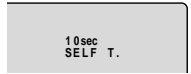

Audio mode (p. 48)



Data code (p. 35)

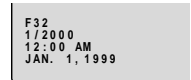

Volume level (p. 18)

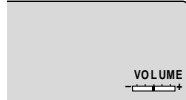

Screen brightness (p. 80)

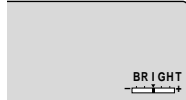

DV input (p. 72)



Photo mode (p. 37)



Setting the AF/AE mark flashes white



AF/AE locked mark lights up green



Recording programs (p. 41)



Manual exposure display (p. 53):
Exposure locked

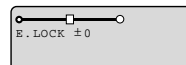

Brighter than standard exposure level

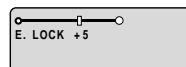

Darker than standard exposure level

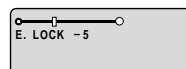

Manual focus is selected (p. 52).



White balance is (p. 56).

Set
Outdoor
Indoor

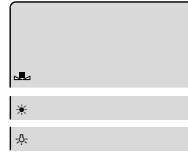

The 16:9 effects: the display flashes when the effect is being selected, and appears steadily when it is activated (p. 47).

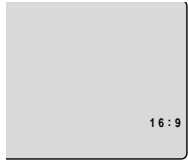

Digital effects functions. The display flashes when the function is being selected and appears steadily when it is activated (p. 45).



The wind screen is turned off (p. 49).



Audio output (p. 78)

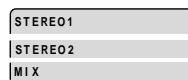

Mix balance (p. 78)



Condensation warning (p. 82)



Time Code

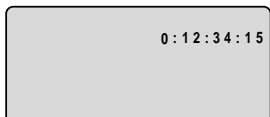

This records counter information, including hour, minute, second, and frame number on a special data code area on the tape itself. It is reset automatically when a new tape is loaded. In camera mode, the frame number doesn't appear.

Recording reminder

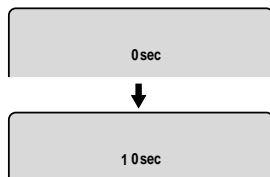

When you start recording, the camera counts from 0SEC to 10SEC. Shots which are shorter than 10 seconds may be difficult to edit later. On the other hand, if you are not planning to edit the recording, remember that a shot which does not contain action should generally last no longer than 10 seconds.

Caution phrases

The camera displays various caution phrases — they appear for 4 seconds before disappearing.

Appears each time you turn the power on, until you set the date and time (p. 31).



Appears when the battery pack is exhausted (p. 9, 75).



Appears when the tape has reached the end.



Refer to page 11.



Refer to page 82.

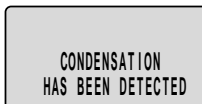

Appears as a warning to protect the tape and also when condensation is detected. Remove the tape as soon as possible after the camera has displayed the caution.

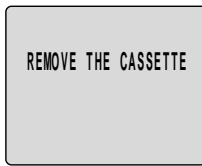

Refer to page 73.



Refer to page 73.

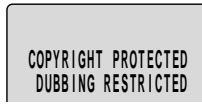

Appears when you press the DV REC button if the DV cable is not connected properly (p. 72).

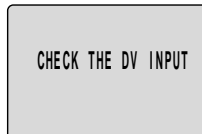

Specifications

ULTURA

E

Power Supply (rated): 7.2 V DC
Power Consumption (while recording with the AF turned on):

5.4 W (Using view-finder), 6.2 W (Using LCD screen)

Television system:
EIA standard (525 lines, 60 fields)
NTSC color signal

Video recording system:
2 rotary heads, helical scanning
DV system (Consumer digital VCR SD system)

Digital component recording

Audio recording system: PCM digital sound: 16 bit (48kHz/2ch), 12 bit (32kHz/4ch)

Image sensor: 1/4" CCD (charge coupled device) 390,000 pixels (360,000 effective pixels)

Tape format: Videocassettes bearing the ^{Mini}DV mark.

Tape speed:
SP: 3/4 ips (18.81 mm/s);
LP: 1/2 ips (12.56 mm/s)

Maximum recording time:
SP: 80 minutes (with an 80 min. cassette);
LP: 120 minutes (with an 80 min. cassette)

Fast forward/rewind time:
Approx. 2 min. 50 sec. (with a 60 min. cassette)

Lens: F/1.8–2.6, 16× power zoom, 3.9–62.4 mm

Focusing system: TTL autofocus, manual focusing possible

Minimum focusing distance: 2 5/8 feet (80 cm) (3/8 inch (1 cm) on maximum wide angle)

Maximum shutter speed: 1/8,000 sec

Minimum illumination: 2 lx (using the Low Light program)

Recommended illumination:

More than 100 lx

Filter diameter: 37.5 mm

Viewfinder: 0.55-inch, color LCD (approx. 113,000 pixels)

LCD screen: 2.5 in measured diagonally, 120,000 pixels (approx.)

Microphone: Stereo electret condenser microphone

DV Terminal: Special 4-pin connector (conforms to IEEE 1394)

Output level:
Video terminal: 1 Vp-p/75 ohms unbalanced

S-video terminal: 1 Vp-p (Y signal), 0.286 Vp-p (C signal)

Audio terminal: –10dBV, less than 3 kohms, unbalanced

Operating temperature range: 32–104 °F (0–40 °C)

Dimensions: 3 × 3 7/8 × 6 1/8 in (76 × 100 × 157 mm)

Weight: 1lb 9 3/8 oz approx. (720 g)

BP-915 Battery Pack

Battery type: Rechargeable lithium ion battery

Rated voltage: 7.2 V DC

Operating temperature: 32°–104°F (0°–40°C)

Battery capacity: 1,500 mAh

Dimensions: 1 1/2 × 3/4 × 2 3/4 in (38.2 × 20.5 × 70.5 mm)

Weight: 3 3/8 oz (96 g)

Weight and dimensions are approximate. Errors and omissions excepted.

Subject to change without notice.

Canon is a trademark of Canon Inc.

Index

E

A

Abroad, Using the Camera, 81
Accessories, 5, 87
Adapter, AC, 8
AE Programs, 41
Art, 45
Audio Output, 78
Audio Recording and Playback, 48
Audio/Video Terminals, 22
Auto, 48
Auto Editing, 59
Autofocus, 51

B

Backup Battery, 76
Basic Recording, 12
Battery Pack, 9
Black and White, 45

C

Cables, 6, 22
Cassettes, 10
Charging the Battery Pack, 9
Choosing a Recording Program, 41
Cleaning the Camera, 80
Condensation, 82
Connection to TV or VCR, 22

D

Date and Time, 31
Digital Effects, 45
Digital Video, 7
Digital Zoom, 15
Displaying Data Code, 35
DV Terminal, 71

E

Easy Recording, 42
Editing, 71
Exposure, 53
External Microphone, 48

F

Fade Trigger, 45
Fast Forward, 19
Feedback, 22
Finding Your Way Around the
ULTURA, 94
FlexiZone, 43
FlexiZone Control, 51
Focusing, 51

H

Head Cleaning, 80
Headphones, 48
Horizontal Wipe, 45

I

Image Stabilizer, 25
Introducing the ULTURA, 7

L

LANC, 71
LCD Screen, 16
Lens Cap, 74
Loading Cassettes, 10
Low Light, 44
LP Mode, 14

M

Maintenance, 79
Making Better Videos, 23
Manual Exposure Control, 53
Manual Focus, 52
Menus, 26, 27
Mirror Mode, 17
Monitor Recording, 17

O

Optical Image Stabilizer, 25
Optional Accessories, 87

P

Pause, Record, 12
 Photo Mode, 37
 Photo Search, 39
 Playback, 19
 Playback Connection, 22
 Playback Pause, 20
 Portrait, 43
 Power Adapter, 8
 Powering Your Camcorder, 8
 Pre-Marked Position, 58
 Preparing the Camera, 74
 Problems, 83

R

Recharging the Battery Pack, 75
 Record Pause Mode, 12
 Record Review, 40
 Record Search, 40
 Recorder, 61
 Recording, 12
 Recording Programs, 41
 Remote Control, 29
 Remote Sensor, 29
 Rewind, 19

S

S-video, 22
 Sand & Snow, 44
 Screen Displays, 94
 Self-Timer, 50
 Sepia, 46
 Shoulder Strap, 74
 Shutter Speed, 55
 16:9, 47
 SP Mode, 14
 Speaker, 18
 Specifications, 98
 Sports, 43
 Spotlight, 44
 Standby Level, 12
 Storage, 79
 Strobe, 46
 System Diagram, 86

T

Tally Lamp, 30
 Tape Protection, 11
 Telephoto, 15
 Temperature, 75, 79
 Time Code, 97
 Time Zone, 31
 Tripod, 23
 Troubleshooting, 83
 TV, 22, 94

U

Using the Camera Abroad, 81
 Using the Menus, 26, 27

V

VCR, 22
 Vertical Wipe, 45
 Video Heads, 80
 Videocassettes, 10
 Viewfinder, 74, 80

W

White Balance, 56
 Wide-angle, 15
 Wind Screen, 49
 Wireless Controller, 29

Z

Zero Set Memory, 58
 Zooming, 15

U.S.A.

CANON® ULTURA DIGITAL VIDEO CAMCORDER LIMITED WARRANTY

E

The limited warranty set forth below is given by Canon U.S.A., Inc. ("CUSA") with respect to each Canon ULTURA Digital Video Camcorder ("DV Camcorder") purchased and used in the United States.

Each Canon DV Camcorder, when delivered to you in new condition in its original container, is warranted against defective material or workmanship as follows: for a period of one (1) year from the date of original purchase (three (3) months in the case of the video head part), defective parts or DV Camcorders returned to a CUSA factory service center ("CUSA Center") or an authorized DV Camcorder service facility ("Service Facility"), and proven to be defective upon inspection, will be repaired or exchanged for new or comparable rebuilt parts or DV Camcorders. The warranty period for repaired or replacement parts or DV Camcorders shall begin upon shipment of the same, but shall in no event exceed the original warranty period of the defective part or DV Camcorder.

Non-Canon brand peripheral equipment and software which may be distributed with Canon DV Camcorders are sold "AS IS", without warranty of any kind by CUSA, including any implied warranty regarding merchantability or fitness for a particular purpose. The sole warranty with respect to such non-Canon brand items is given by the manufacturer or producer thereof.

CUSA shall have no responsibility under this limited warranty for use of Canon DV Camcorders in conjunction with incompatible peripheral equipment and incompatible software.

In order to obtain warranty service, contact the authorized Canon retail dealer from whom you purchased the DV Camcorder or call the CANON INFORMATION CENTER AT 1-800-828-4040 (which is open from 9:00 a.m. to 5:00 p.m. (E.S.T.), Monday through Friday, excluding holidays). Have your unit serial number and your date of purchase available when you make the call to expedite service. In either case you will be directed to ship the DV Camcorder, postage prepaid, to the CUSA Center or Service Facility nearest to you. You must include a copy of the proof of purchase (bill of sale) and a complete explanation of the problem. DV Camcorders covered by this limited warranty will be repaired and returned to you without charge by the CUSA Center or the Service Facility. Repairs not under warranty will be at such cost as the CUSA Center or Service Facility may from time to time generally establish.

This limited warranty covers all defects encountered in normal use of the DV Camcorder, and does not apply in the following cases:

- (a) Loss of or damage to the DV Camcorder due to abuse, mishandling, improper packaging by you, alteration, accident, leaking batteries, exterior nicks, scratches or dents, electrical current fluctuations, failure to follow operating instructions, maintenance and environmental instructions prescribed in CUSA's instruction manual, or service performed by other than a CUSA Center or Service Facility.
- (b) Use of parts or supplies (other than those sold by CUSA) which cause damage to the DV Camcorder or cause abnormally frequent service calls or service problems.
- (c) If any DV Camcorder has had its serial number or dating altered or removed.

This limited warranty does not apply to accessories or consumables for the DV Camcorder, which are sold "AS IS", without warranty of any kind by CUSA.

NO IMPLIED WARRANTY, INCLUDING ANY IMPLIED WARRANTY OF MERCHANTABILITY OR FITNESS FOR A PARTICULAR PURPOSE, APPLIES TO THE DV CAMCORDER AFTER THE APPLICABLE PERIOD OF EXPRESS WARRANTY STATED ABOVE, AND NO OTHER EXPRESS WARRANTY OR GUARANTY, EXCEPT AS MENTIONED ABOVE, GIVEN BY ANY PERSON, FIRM OR CORPORATION WITH RESPECT TO THE DV CAMCORDER SHALL BIND CUSA. (SOME STATES DO NOT ALLOW LIMITATIONS ON HOW LONG AN IMPLIED WARRANTY LASTS, SO THE ABOVE LIMITATION MAY NOT APPLY TO YOU) CUSA SHALL NOT BE LIABLE FOR LOSS OF REVENUES OR PROFITS, EXPENSE FOR SUBSTITUTE EQUIPMENT OR SERVICE, STORAGE CHARGES, LOSS OF DATA, OR ANY OTHER SPECIAL, INCIDENTAL OR CONSEQUENTIAL DAMAGES CAUSED BY THE USE, MISUSE OR INABILITY TO USE THE DV CAMCORDER, REGARDLESS OF THE LEGAL THEORY ON WHICH THE CLAIM IS BASED, AND EVEN IF CUSA HAS BEEN ADVISED OF THE POSSIBILITY OF SUCH DAMAGES. NOR SHALL RECOVERY OF ANY KIND AGAINST CUSA BE GREATER IN AMOUNT THAN THE PURCHASE PRICE OF THE DV CAMCORDER SOLD BY CUSA AND CAUSING THE ALLEGED DAMAGE. WITHOUT LIMITING THE FOREGOING, YOU ASSUME ALL RISK AND LIABILITY FOR LOSS, DAMAGE OR INJURY TO YOU AND YOUR PROPERTY AND TO OTHERS AND THEIR PROPERTY ARISING OUT OF USE, MISUSE OR INABILITY TO USE THE DV CAMCORDER NOT CAUSED DIRECTLY BY THE NEGLIGENCE OF CUSA. (SOME STATES DO NOT ALLOW THE EXCLUSION OR LIMITATION OF INCIDENTAL OR CONSEQUENTIAL DAMAGES, SO THE ABOVE LIMITATION MAY NOT APPLY TO YOU). THIS LIMITED WARRANTY SHALL NOT EXTEND TO ANYONE OTHER THAN THE ORIGINAL PURCHASER OF ANY DV CAMCORDER, OR THE PERSON FOR WHOM IT WAS PURCHASED AS A GIFT, AND STATES YOUR EXCLUSIVE REMEDY.

This limited warranty gives you specific legal rights, and you may also have other rights which vary from state to state.

Canon U.S.A., Inc.
One Canon Plaza
Lake Success, New York 11042

**Additional
Information**

CANADA

E

CANON CONSUMER DIGITAL VIDEO EQUIPMENT LIMITED WARRANTY

The limited warranty set forth below is given by Canon Canada Inc. ("Canon Canada") with respect to Canon digital video equipment purchased in Canada. This limited warranty is only effective upon presentation of a bill of sale or other proof of purchase for this Canon digital video equipment to a Canon Service Facility when repairs are required.

Canon consumer video digital equipment is warranted under normal, non-commercial, personal use, against defective materials or workmanship as follows:

Parts: Defective parts will be exchanged for new parts or, at Canon Canada's option, comparable rebuilt parts for a period of one year from the date of original purchase, except Video Heads which will be exchanged for a period of 3 months from the date of purchase.

Labour: For a period of one year from the date of original purchase, labour will be provided free of charge by our Canon Service Facilities in Canada.

This limited warranty covers all defects except where:

- (a) The loss or damage to the product results from:
 - i) accident, natural disaster, mishandling, abuse, neglect, unauthorized product modification or failure to follow instructions contained in the instruction manual;
 - ii) the use of accessories, attachments, products, supplies, parts or devices with this Canon product that do not conform to Canon specifications or that cause abnormally frequent service problems;
 - iii) repairs or services performed by any party other than a Canon Service Facility;
 - iv) defective batteries or any exposure to water, sand or dirt;
 - v) shipping (claim must be presented to the shipper);
- (b) Any serial number on the video equipment is altered or removed.
- (c) The digital video equipment is used for commercial, professional or industrial purposes.

This limited warranty does not cover the cabinet (exterior finish) of the digital video equipment, video cassette tapes, head cleanings, nor does it apply to digital video equipment purchased outside Canada.

TO OBTAIN WARRANTY SERVICE

Ship your Canon digital video equipment in its original carton, box or equivalent, properly packed, fully insured with shipping charges prepaid, together with a copy of your bill of sale or other proof of purchase and a description of the problem to any of the Canon Service Facilities in Canada.

LIMITATIONS

Except as otherwise required by applicable legislation, this warranty is in lieu of all other warranties, conditions, guarantees or representations, express or implied, statutory or otherwise, relative to this Canon product, including implied warranties or conditions of merchantability or fitness for a particular purpose.

Canon Canada assumes no liability for special, consequential or incidental damages or loss that may arise, whether on account of negligence or otherwise, from the use, misuse or inability to use this Canon product (including loss of profit, revenue, video tapes or enjoyment) or from failure to conform to any express or implied warranties, conditions, guarantees or representations. Any recovery under this limited warranty shall not exceed the purchase price of the product. Canon Canada does not assume or authorize any other person to assume for Canon Canada any other liability with respect to this Canon product.

This warranty does not extend to any person other than the original purchaser of this Canon product or the person for whom it was purchased as a gift and states your exclusive remedy.

NOTICE TO CONSUMER

If you plan to take important videos or if the product has not been used for some time, please check all functions with the instruction book before using it.



CANON INC.

U.S.A. ————— **CANON U.S.A., INC. NEW JERSEY OFFICE**
100 Jamesburg Road, Jamesburg, NJ 08831 USA

CANON U.S.A., INC. CHICAGO OFFICE
100 Park Blvd., Itasca, IL 60143 USA

CANON U.S.A., INC. LOS ANGELES OFFICE
15955 Alton Parkway, Irvine, CA 92718 USA

CANON U.S.A., INC. HONOLULU OFFICE
1020 Auahi Street, Bldg. #8, Honolulu, HI 96814 USA

- **If you have any questions, call the Canon U.S.A. Information Center toll-free at 1-800-828-4040 (U.S.A. only).**

CANADA ————— **CANON CANADA INC. NATIONAL HEADQUARTERS**
6390 Dixie Road, Mississauga, Ontario L5T 1P7

CANON CANADA INC. CALGARY
2828, 16th Street, N.E. Calgary, Alberta T2E 7K7

CANON CANADA INC. MONTREAL
5990 Côte de Liesse, Quebec H4T 1V7

- **If you have any questions, call the Canon Canada Information Center toll-free at 1-800-828-4040. (Canada only)**

- **Si vous avez des questions, veuillez téléphoner sans frais au Canada 1-800-828-4040. (Canada seulement)**

MEXICO ————— **CANON MEXICANA, S. DE R.L. DE C.V.**
Periferico Sur No. 4124 Col. Ex-Rancho de Anzaldo C.P. 01900
México, D.F., México

CENTRO Y SURAMÉRICA ————— **CANON LATIN AMERICA, INC.**
6505 Blue Lagoon Drive Suite 325 Miami FL 33126 USA

ASIA ————— **CANON HONGKONG COMPANY LTD.**
9/F, The Hong Kong Club Building, 3A Chater Road, Central, Hong Kong